



हिन्दी  
ENGLISH



## GB210

यह निर्देशिका आपकी आपके नए मोबाइल को समझने में मदद करेगी. यह आपको आपके फोन में दी गई सुविधाओं के बारे में उपयोगी जानकारी देता है.

इस निर्देशिका की कुछ सामग्री आपके फोन के सॉफ्टवेयर या आपके सेवा प्रदाता के आधार पर आपके फोन से अलग हो सकती है.



[www.lgmobile.com](http://www.lgmobile.com)

P/N : MMBB0324402 (1.1)

CE 0168

Downloaded from <http://www.gsmarc.com>

# GB210 User Guide - English

This guide will help you understand your new mobile phone. It will provide you with useful explanations of features on your phone.

Some of the contents in this manual may differ from your phone depending on the software of the phone or your service provider.



# Getting to know your phone

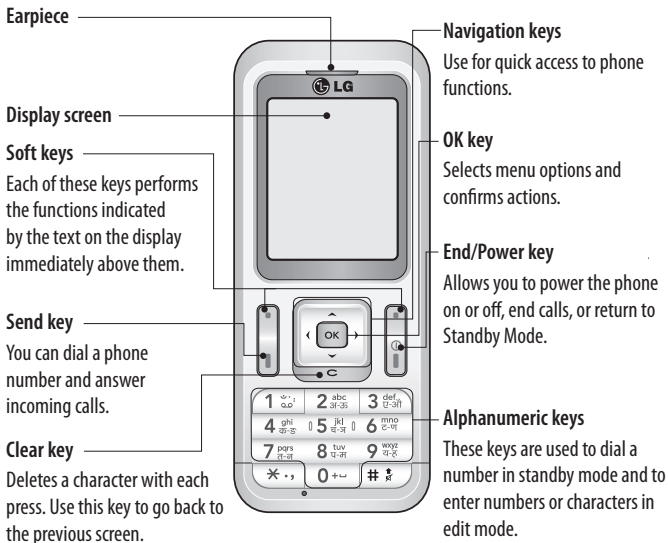

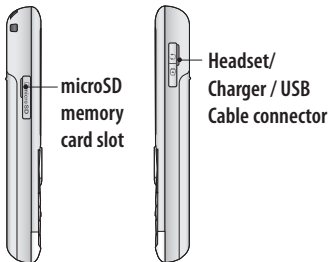

#### Note: Auto key lock

To prevent unintended operation of your phone, the keypad protection function is automatically enabled.

To disable keypad protection, press the left soft key **Unlock** and then press the right soft key **Yes**.

If you want to change the setting of this function, press **Menu > Settings > Security**, and choose **Auto key lock**. Select **Off** or set the amount of time before Auto key locks.

## Installing a memory card

Lift the memory card cover and insert a micro SD card with the golden contact area facing downwards. Close the memory card cover so that it clicks shut.

To remove a memory card, gently push it as shown in the diagram.

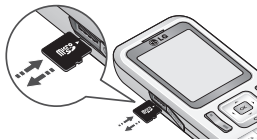

**Note:** A memory card is an optional accessory.

## Formatting the memory card

Press **Menu** and select **Settings**.

Choose **Memory status**, select **External memory** and press **Format**.

**WARNING:** When you format your memory card, all the content will be wiped. If you do not want to lose the data on your memory card, back it up first.

# Installing the SIM Card and Charging the Battery

## Installing the SIM Card

When you subscribe to a cellular network, you are provided with a plug-in SIM card loaded with your subscription details, such as your PIN, any optional services available and many others.

**Important!** > The plug-in SIM card and its contacts can be easily damaged by scratches or bending, so be careful when handling, inserting or removing the card. Keep all SIM cards out of the reach of small children.

## Illustrations

- 1 Open battery cover
- 2 Remove the battery
- 3 Insert your SIM
- 4 Insert the battery
- 5 Close the battery cover
- 6 Charge your battery

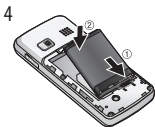
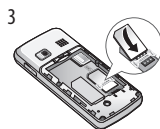
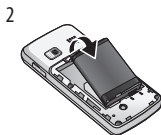
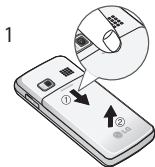

**WARNING:** Do not remove the battery when the phone is switched on, as this may damage the phone.

# Menu map

## Games & Apps

- 1 Games
- 2 Applications
- 3 Network profiles

## Call history

- 1 All calls
- 2 Missed calls
- 3 Dialed calls
- 4 Received calls
- 5 Call duration
- 6 Call costs
- 7 Data information

## Organizer

- 1 Calendar
- 2 Memo
- 3 To do

## Multimedia

- 1 MP3 player
- 2 Camera
- 3 Video camera
- 4 FM radio
- 5 Voice recorder

## Messaging

- 1 New message
- 2 Inbox
- 3 Bluetooth box
- 4 Drafts
- 5 Outbox
- 6 Sent
- 7 Listen to voicemail
- 8 Info messages
- 9 Templates
- 0 Settings

## My stuff

- 1 Images
- 2 Sounds
- 3 Videos
- 4 Others
- 5 External memory

## Profiles

- 1 General
- 2 Silent
- 3 Vibrate only
- 4 Outdoor
- 5 Headset

## Contacts

- 1 Search
- 2 New contact
- 3 Speed dial
- 4 Groups
- 5 Copy all
- 6 Delete all
- 7 Settings
- 8 Information

## Tools

- 1 Alarm clock
  - 2 Calculator
  - 3 Stopwatch
  - 4 Unit converter
  - 5 World clock
  - 6 SIM services\*
- \* This feature depends on SIM and the network services.

## Browser

- 1 Home
- 2 Google Search
- 3 Bookmarks
- 4 Enter address
- 5 History
- 6 Saved pages
- 7 Settings
- 8 Information

## Connectivity

- 1 Bluetooth
- 2 Network
- 3 USB connection

## Settings

- 1 Date & Time
- 2 Languages
- 3 Display
- 4 Shortcut
- 5 Call
- 6 Security
- 7 Flight mode
- 8 Power save
- 9 Reset
- 0 Memory status

# Calls



## Making a call

- 1 Key in the number using the keypad. To delete a digit press .
- 2 Press Send key to initiate the call.
- 3 To end the call, press End key.

**TIP!** To enter + when making an international call, press and hold 0.

**TIP!** To adjust the volume during a call, use  < [and] > .

## Making a call from your contacts

- 1 Press  to open the address book.
- 2 Using the keypad, enter the first letter of the contact you want to call. For example, for Office, press 6 three times.
- 3 To scroll through the contacts and their different numbers use  and .
- 4 Press Send key to initiate the call.

## Answering and rejecting a call

When your phone rings, press **Accept** or press Send key to answer the call.

While your phone is ringing, select **Silent** to mute the ringing. This is great if you have forgotten to change your profile to **Silent** for a meeting.

Press End key or **Reject** to reject the incoming call.

**Note:** The rejected call will appear under Missed Call list.

## Using the speakerphone

During a call, you can activate speakerphone by pressing OK key and you can use the handset in hands-free.

If the speakerphone is active, press OK key again to resume normal handset conversation mode.

## Viewing your call logs

You can check the record of missed, received, and dialled calls only if the network supports the Calling Line Identification (CLI) within the service area. The number or name (if available) is displayed with the date and time at which the call was made You can also

view call durations. Press **Menu**, select **Call history**.

## Changing the call settings



You can set the menu relevant to a call. Press **Menu**, select **Settings** and choose **Call**.

- **Call divert** - Choose whether to divert your calls.
- **Call barring** – Select when you would like calls to be barred.
- **Fixed dial number** – Choose a list of numbers that can be called from your phone. You'll need your PIN2 code from your operator. Only numbers included in the fixed dial list can be called from your phone.
- **Answer mode** - Choose whether to answer the phone using any key or send key only.
- **Send my number** - Choose whether your number will be displayed when you call someone. (Depends on your network provider.)
- **Call waiting** - Be alerted when you have a call waiting. (Depends on your network provider.)

- **Minute minder** - Select **On** to hear a tone every minute during a call.
- **Auto redial** - Choose **On** or **Off**.
- **Send DTMF tones** - Choose **On** or **Off**.

## Contacts

### Searching for a contact



- 1 Press **Contacts** and choose **Search**, select **Contacts** from the **Menu** screen or press  from the standby screen.
- 2 Using the keypad enter the first letter of the contact you want to call. For example, for **Office**, press **6** three times. Then press **Search**.
- 3 To scroll through the contacts and their different numbers use  and .

**TIP!** There are two LG Mobile customer care numbers provided in phone book. You can directly call the LG Customer Care I or edit LG Customer Care II with area code and make the call.



## Adding a new contact

- 1 Press **Contacts** and choose **New contact**.
- 2 Choose whether to store your new contact on your **Phone** or **SIM** card.
- 3 Enter all the information you have in the fields provided and select **Save**.

**Note:** When you are storing a contact's email address, press  to enter a symbol and scroll with  and  until you see @.

## Messaging

Your GB210 includes functions related to SMS (Short Message Service), MMS (Multimedia Message Service) and Bluetooth, as well as the network's service messages.

### Sending a message

- 1 Press **Menu**, select **Messaging** and choose **New message**.
- 2 Choose **Message** to send an SMS or MMS.
- 3 A new message editor will open. Message editor combines SMS and MMS into one intuitive and easy to switch between SMS

mode and MMS mode. The default setting of the message editor is SMS mode.

- 4 Enter your message using either the T9 predictive mode or Abc manual mode. You can switch text input mode by pressing .
- 5 Press **Options** and choose **Insert** to add an **Image**, **Sound**, **Video**, **Symbol**, **Text template**, **Emoticon**, **Name & Number**, **New slide**, **Subject** or **More (Contact/My business card/Schedule/Memo/To do)**.
- 6 Press **Options** and choose **Send to**.
- 7 Enter the phone number or press **Options** and select **Contacts** or **Recent list** to open your contacts list. You can add multiple contacts.
- 8 Press OK key.

**TIP!** You can select your message type as SMS or MMS when you enter a text longer than 1 page in the message field. If you want to change the type of message to send, press **Menu > Messaging > Settings > Text message**, and choose **Send long text as**.

**WARNING:** If an Image, Sound, Video, New slide or Subject is added to the message editor, it will be automatically converted to MMS mode and you will be charged accordingly.

**Note:** You can send SMS to many users at a time. Option **Send to Many** will open the contacts list where in user can mark/unmark contacts for sending message. First 100 contacts marked will be chosen if **Mark all** is selected. To send the SMS to a particular group of contacts select the option **Send to Group** after composing the SMS.

## Bluetooth message

To send/receive the message via Bluetooth, you should switch on the Bluetooth.

## Bluetooth box

All messages you receive via Bluetooth are placed into your Bluetooth Inbox. Here you can read, reply to and forward your messages.

## Entering text

You can enter alphanumeric characters using the phone's keypad. The following text

input methods are available in the phone: T9 predictive mode, ABC manual mode and 123 mode.

**Note:** Some fields may allow only one text input mode (e.g. telephone number in address book fields).

## T9 predictive mode

T9 predictive mode uses a built-in dictionary to recognise words you're writing based on the key sequences you press. Simply press the number key associated with the letter you want to enter, and the dictionary will recognise the word once all the letters are entered.

## ABC manual mode

This mode allows you to enter letters by pressing the key labeled with the required letter once, twice, three or four times until the letter is displayed.

## 123 mode

Type numbers using one keystroke per number. You can also add numbers while

remaining in letter modes by pressing and holding the desired key.

## MP3 player

Your GB210 has a built-in MP3 player so you can play all your favourite music.

### Playing a song

- 1 Press **Menu** and select **Multimedia**, then choose **MP3 player**.
- 2 Choose **All songs** then select the song you want to play. Press OK (▶) key.
- 3 While music is playing, press OK key to pause the song.
- 4 Press ▶▶ to skip to the next song.
- 5 Press ◀◀ to skip to the previous song.
- 6 While music is playing, press OK key and select ◀ to stop the music and return to the MP3 player menu.

**TIP!** To change the volume while listening to music, use ▲ and ▼.

**TIP!** When an MP3 track is playing on the MP3 player, if you press ◀, you can use BGM mode. In BGM (Background Music) mode, MP3 can be played while other functions are being used. BGM can be stopped on the MP3 player screen.

## Camera

### Taking a quick photo

Using the camera module built in your phone, you can take pictures of people. Additionally, you can send photos to other people and select photos as wallpaper.

- 1 Press **Menu** and select **Multimedia**, select **Camera** to open the viewfinder.
- 2 Holding the phone vertically, point the lens towards the subject of the photo.
- 3 Press OK key to take a photo.

## Video camera

### Shooting a quick video

You can record and save a video clip.

- 1 Press **Menu** and select **Multimedia**, scroll down and select **Video camera** to open the viewfinder.
- 2 Point the camera lens towards the subject of the video.
- 3 Press OK key to start recording.
- 4 **REC** will appear in the viewfinder and a timer will show the length of your video.
- 5 Press **Stop** to stop recording.

## FM radio

Your GB210 has an FM radio feature so you can tune into your favourite stations to listen on the move.

**Note:** You will need to insert your headset in order to listen to the radio. Insert the plug into the headset socket (this is the same socket that you plug your charger into).

### Listening to the radio

- 1 Press **Menu** and select **Multimedia**, then choose **FM radio**.
- 2 Select the channel number of the station you would like to listen to.

**TIP!** To change the volume while listening to the radio, use  and .

**TIP!** You can listen to the radio via built-in speaker. Press **Options**, select **Listen via** and choose **Speaker**.

**TIP!** While listening FM Radio through headset, you can change the FM radio channel through short press of headset key. If the headset is in deep sleep mode and keypad is locked, long press of headset key will turn on backlight also simultaneously change the FM radio channel.

## Voice recorder

Use your Voice recorder to record voice memos or other sounds.

### Recording your voice memo

- 1 Press **Menu** and select **Multimedia**, then choose **Voice recorder**.
- 2 Press OK key to begin recording.
- 3 Choose **Stop** to end the recording.
- 4 Press **Options** and choose **Play** to listen to the voice memo.

**TIP!** You can listen to all of the voice recordings you have saved by selecting **Options** and **Album**.

## My stuff

You can store any multimedia files into your phone's memory so that you have easy access to all of your images, sounds, videos, others and games. You can also save your files to a memory card. The advantage of using a memory card is that you can free up space on your phone's memory. All your multimedia files will be saved in **My stuff**. Press **Menu** then select **My stuff** to open a list of folders.

## Games and Apps

Your GB210 comes with preloaded games to keep you amused when you have time to spare. If you choose to download any additional games or applications they will be saved into this folder. Press **Menu** and select **Games & Apps**.

GB210 also comes with preloaded applications.

- **Data Wallet** - This application is used to keep personal informations. (Bank Account / Credit Card / Loan / Email ID details)
- **LG Help Desk** - This application has all India LG Mobile service centre / Call Centre numbers directory.

## Organizer / Tools

### Using the calendar

( **Menu** > **Organizer** > **Calendar** )

When you enter this menu, a calendar appears. A square cursor is located on the current date. You can move the cursor to another date using the navigation keys.

### Adding a memo

( **Menu** > **Organizer** > **Memo** )

You can register your own memos here.

### Adding an item to your to do list

( **Menu** > **Organizer** > **To do** )

You can view, edit and add tasks to do.

## Setting your alarm

( Menu > Tools > Alarm clock )

You can set up to 5 alarm clocks to go off at a specified time.

## Using your calculator

( Menu > Tools > Calculator )

The calculator provides the basic arithmetic functions: addition, subtraction, multiplication and division.

## Using the stopwatch

( Menu > Tools > Stopwatch )

This option allows you to use the function of a stopwatch.

## Converting a unit

( Menu > Tools > Unit converter )

This converts many measurements into a unit you want.

## Adding a city to your world clock

( Menu > Tools > World clock )

You can add a required city to the list of world clock. You can also check the current time of

Greenwich Mean Time (GMT) and major cities around the world.

## SIM services

( Menu > Tools > SIM services )

This feature depends on SIM and the network services. In case the SIM card supports SAT (i.e. SIM Application Toolkit) services, this menu will be the operator specific service name stored on the SIM card.

## Browser

### Accessing the browser

You can launch the wap browser and access the homepage of the activated profile on browser settings. You can also manually enter an URL address and access the associated wap page.

- 1 Press **Menu** and select **Browser**.
- 2 To access the browser homepage directly, select **Home**. Alternately, select **Enter address** and type in your desired URL.

**Note:** An additional cost is incurred when connecting to this service and downloading content. Check your data charges with your network provider.

## Google Search

You can access Google Mobile Internet Service. To access Google Search services, press **Menu** and select **Browser** then **Google Search**.

**Note:** This is dependent on Network Services. You may be unable to access **Google Search** in some countries.

## Connectivity

### Changing your connectivity settings ( **Menu** > **Connectivity** )

Your connectivity settings have already been set up by your network operator, so you can enjoy your new phone from switch on. If you want to change any settings, use this menu. You can configure the network setting and data access profiles in this menu.

- **Bluetooth** - Setup your GB210 for Bluetooth® use. You can adapt your visibility to other devices or search through devices your phone is paired with.
- **Network** - Your GB210 connects automatically to your preferred network. To change these settings use this menu. You can also add new access points using this menu.
- **USB connection** - Choose **Data service** and synchronise your GB210 using the LG PC Suite software to copy files from your phone. If you have a memory card inserted, select **Mass storage** to use your phone in the same way as you would use a USB stick. Connect to your computer and drag and drop files to the GB210 removable device folder.

**Note:** To use the USB mass storage function, you will need to insert an external memory card in your phone.

## Changing your Bluetooth settings

- 1 Press **Menu** and select **Connectivity**.  
Choose **Bluetooth**.
- 2 Choose **Bluetooth settings**. Make your changes to:
  - **My visibility** - Choose whether to **Show** or **Hide** your device to others.
  - **My name** - Enter a name for your LG GB210.
  - **My address** - View your Bluetooth address.
  - **Primary storage** - Choose the default location you prefer items to be saved to.

**Note:** To use the primary storage function, you will need to insert an external memory card in your phone.

## Pairing with another Bluetooth device

By pairing your GB210 and another device, you can set up a passcode protected connection. This means your pairing is more secure.

- 1 Check your Bluetooth is **On** and **Visible**.  
You can change your visibility in the **Bluetooth settings** menu, by selecting **My visibility**, then **Show**.

- 2 Select **Device list** from the **Bluetooth** menu and choose **New**.
- 3 Your GB210 will search for devices. When the search is completed **Pair** and **Refresh** will appear on screen.
- 4 Choose the device you want to pair with, select **Pair** and enter the passcode then choose OK key.
- 5 Your phone will then connect to the other device, on which you should enter the same passcode.
- 6 Your passcode protected Bluetooth connection is now ready.

## Profiles

### Changing your profiles

(Menu > Profiles)

You can quickly change your profile from the standby screen. Simply press **⏏** then choose the profile you would like to activate. Choose from **General**, **Silent**, **Vibrate only**, **Outdoor** and **Headset**.



## Settings

### Changing your date & time

( Menu > Settings > Date & Time )

You can set functions relating to the date and time.

### Changing the language

( Menu > Settings > Languages )

You can change the language for the display texts in your phone. This change will also affect the language input mode.

### Changing your display settings

( Menu > Settings > Display )

You can change the settings for the phone display.

### Changing your shortcuts settings

( Menu > Settings > Shortcuts )

You can change the shortcuts of 4 navigation keys.

### Changing your security settings

( Menu > Settings > Security )

Change your security settings to keep your GB210 and the important information it holds protected.

- **PIN code request** - Choose a PIN code to be requested when you turn your phone on.
- **Auto key lock** - If you activate this function, the key will be locked automatically in standby mode without requesting the action of key.
- **Phone lock** - Choose a security code to lock your phone, **When power on**, **When SIM changed** or **Immediately**.
- **Application lock** - You can set the application lock to avoid unauthorized use of Images in phone memory, Calendar, Memo and To do. You will need a security code.
- **Anti Theft Mobile Tracker** - When the handset is stolen, handset sends the SMS to the numbers configured by real owner. To activate the ATMT feature, you will need

to set ATMT on, and configure the ATMT settings with name, primary number and secondary number. Default ATMT code is "0000."

ATMT SMS will contain information about the stolen phone IMEI, current location (captured as per Cell Broadcast message) & number of the person who is using that handset.

- **Change codes** - Change your **Security code**, **PIN code** (This menu item will appear if PIN code request is set to On), **PIN2 code** or **ATMT code**.

### Using flight mode

( Menu > Settings > Flight mode )

Use this function to switch the flight mode On or Off. You will not be able to make calls, connect to the Internet, send messages when Flight mode is switched On.

**Note:** Bluetooth can be turned On in Flight mode by manually selecting the option.

### Power save

( Menu > Settings > Power save )

If you set Always on, you can save the battery power. Choose to switch the power save settings **Always on**, **Night only** or **Off**.

### Resetting your phone

( Menu > Settings > Reset )

Use **Reset** to reset all the settings to their factory definitions. You need the security code to activate this function. The default number is "0000".

### Viewing memory status

( Menu > Settings > Memory status )

Your GB210 has three memories available: the phone, the SIM card and an external memory card (you may need to purchase the memory card separately). You can use the memory manager to determine how each memory is used and see how much space is available.

## Guidelines for safe and efficient use

Please read these simple guidelines. Not following these guidelines may be dangerous or illegal.

### **Exposure to radio frequency energy Radio wave exposure and Specific Absorption Rate (SAR) information**

This mobile phone model GB210 has been designed to comply with applicable safety requirements for exposure to radio waves. These requirements are based on scientific guidelines that include safety margins designed to assure the safety of all persons, regardless of age and health.

- The radio wave exposure guidelines employ a unit of measurement known as the Specific Absorption Rate, or SAR. Tests for SAR are conducted using standardised methods with the phone transmitting at its highest certified power level in all used frequency bands.
- While there may be differences between the SAR levels of various LG phone models, they are all designed to meet the relevant guidelines for exposure to radio waves.
- The SAR limit recommended by the International Commission on Non-Ionizing Radiation Protection (ICNIRP) is 2W/kg averaged over 10g of tissue.
- The highest SAR value for this model phone tested by DASY4 for use at the ear is 0.972 W/kg (10g) and when worn on the body is 1.39 W/Kg(10g).
- SAR data information for residents in countries/regions that have adopted the SAR limit recommended by the Institute of Electrical and Electronics Engineers (IEEE), which is 1.6 W/kg averaged over 1g of tissue.

## Guidelines for safe and efficient use (Continued)

### Product care and maintenance

#### WARNING

Only use batteries, chargers and accessories approved for use with this particular phone model. The use of any other types may invalidate any approval or warranty applying to the phone, and may be dangerous.

- Do not disassemble this unit. Take it to a qualified service technician when repair work is required.
- Keep away from electrical appliances such as TVs, radios, and personal computers.
- The unit should be kept away from heat sources such as radiators or cookers.
- Do not drop.
- Do not subject this unit to mechanical vibration or shock.
- Switch off the phone in any area where you are required by special regulations. For example, do not use your phone in hospitals as it may affect sensitive medical equipment.

- Do not handle the phone with wet hands while it is being charged. It may cause an electric shock and can seriously damage your phone.
- Do not to charge a handset near flammable material as the handset can become hot and create a fire hazard.
- Use a dry cloth to clean the exterior of the unit (do not use solvents such as benzene, thinner or alcohol).
- Do not charge the phone when it is on soft furnishings.
- The phone should be charged in a well ventilated area.
- Do not subject this unit to excessive smoke or dust.
- Do not keep the phone next to credit cards or transport tickets; it can affect the information on the magnetic strips.
- Do not tap the screen with a sharp object as it may damage the phone.

## Guidelines for safe and efficient use (Continued)

- Do not expose the phone to liquid or moisture.
- Use the accessories like earphones cautiously. Do not touch the antenna unnecessarily.
- Give full attention to driving.
- Use a hands-free kit, if available.
- Pull off the road and park before making or answering a call if driving conditions so require.

### Efficient phone operation

#### Electronics devices

- Do not use your mobile phone near medical equipment without requesting permission. Avoid placing the phone over pacemakers, i.e. in your breast pocket.
- Some hearing aids might be disturbed by mobile phones.
- Minor interference may affect TVs, radios, PCs, etc.
- RF energy may affect some electronic systems in your vehicle such as car stereos and safety equipment.
- When your vehicle is equipped with an air bag, do not obstruct with installed or portable wireless equipment. It can cause the air bag to fail or cause serious injury due to improper performance.
- If you are listening to music whilst out and about, please ensure that the volume is at a reasonable level so that you are aware of your surroundings. This is particularly imperative when near roads.

#### Road safety

Check the laws and regulations on the use of mobile phones in the area when you drive.

- Do not use a hand-held phone while driving.

## Guidelines for safe and efficient use (Continued)

### Avoid damage to your hearing

Damage to your hearing can occur if you are exposed to loud sound for long periods of time. We therefore recommend that you do not turn on or off the handset close to your ear. We also recommend that music and call volumes are set to a reasonable level.

### Blasting area

Do not use the phone where blasting is in progress. Observe restrictions, and follow any regulations or rules.

### Potentially explosive atmospheres

- Do not use the phone at a refueling point.
- Do not use near fuel or chemicals.
- Do not transport or store flammable gas, liquid, or explosives in the same compartment of your vehicle as your mobile phone and accessories.

### In aircraft

Wireless devices can cause interference in aircraft.

- Turn your mobile phone off before boarding any aircraft.
- Do not use it on the ground without permission from the crew.

### Children

Keep the phone in a safe place out of the reach of small children.

It includes small parts which may cause a choking hazard if detached.

### Emergency calls

Emergency calls may not be available under all mobile networks. Therefore, you should never depend solely on the phone for emergency calls. Check with your local service provider.

## Guidelines for safe and efficient use (Continued)

### Battery information and care

- You do not need to completely discharge the battery before recharging. Unlike other battery systems, there is no memory effect that could compromise the battery's performance.
- Use only LG batteries and chargers. LG chargers are designed to maximize the battery life.
- Do not disassemble or short-circuit the battery pack.
- Keep the metal contacts of the battery pack clean.
- Replace the battery when it no longer provides acceptable performance. The battery pack may be recharged hundreds of times until it needs replacing.
- Recharge the battery if it has not been used for a long time to maximize usability.
- Do not expose the battery charger to direct sunlight or use it in high humidity, such as in the bathroom.
- Do not leave the battery in hot or cold places, this may deteriorate the battery performance.
- There is risk of explosion if the battery is replaced by an incorrect type.
- Dispose of used batteries according to the manufacturer's instructions. Please recycle when possible. Do not dispose as household waste.
- If you need to replace the battery, take it to the nearest authorized LG Electronics service point or dealer for assistance.
- Always unplug the charger from the wall socket after the phone is fully charged to save unnecessary power consumption of the charger.
- Actual battery life will depend on network configuration, product settings, usage patterns, battery and environmental conditions.

# Technical data

## General

Product name : GB210

System : E-GSM 900 / DCS 1800

## Ambient Temperatures

Max : +55°C (discharging)  
+45°C (charging)

Min : -10°C

Bluetooth QD ID B014921

## Declaration of Conformity



### Suppliers Details

Name

LG Electronics Inc

Address

LG Electronics Inc, LG Twin Towers 20,  
Yeouido-dong, Yeongdeungpo-gu, Seoul, Korea 150-721

### Product Details

Product Name

E-GSM 900 / DCS 1800 Dual band Terminal Equipment

Model Name

GB210

Trade Name

LG

CE 0168

### Applicable Standards Details

R&TTE Directive 1999/5/EC

EN 301 489-01 V1.6.1, EN 301 489-07 V1.3.1, EN 301 489-17 V1.2.1  
EN 301 511 V9.0.2  
EN 50360/EN 50361:2001  
EN 60950-1:2001  
EN300328 V1.7.1

### Supplementary Information

The conformity to above standards is verified by the following Notified Body(BABT)

BABT, Balfour House, Churchfield Road, Walton-on-Thames, Surrey, KT12 2TD, United Kingdom  
Notified Body Identification Number : 0168

### Declaration

I hereby declare under our sole responsibility that the product mentioned above to which this declaration relates complies with the above mentioned standards and Directives

Name

Seung Hyeon, Ji / Director

Issued Date

6. Jan. 2009

European Standard Center  
LG Electronics Logistics and Services B.V.  
Veluwezoom 15, 1327 AE Almere, The Netherlands  
Tel. +31 - 36- 547 - 8940, Fax : +31 -36 -547 - 8794  
e-mail : jacob @ lge.com

  
Signature of representative