

# Quick Start

MOTOROLA ATRIX™ HD

smart  
meets  
life.



4G  
LTE



## At a Glance



For help with your phone, visit [att.com/Tutorials](http://att.com/Tutorials)

## Start

Insert your microSIM, charge up, then power up.

**Note:** This product uses a non-removable battery.

**Caution:** Before assembling, charging, or using your phone for the first time, please read the important safety, regulatory and legal information in this guide.

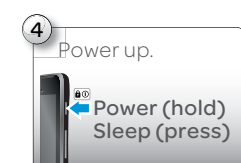
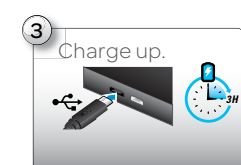
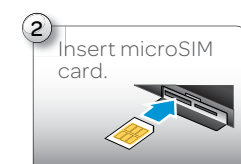
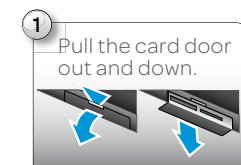

## AT&T Ready2Go

AT&T Ready2Go helps you set up your new device using the browser on your computer.

- 1 From the home screen, touch Apps > **AT&T Ready2Go**.
- 2 Touch **Get Started**. You'll see a web address and a code.
- 3 On your computer's browser, go to the web address.
- 4 Enter your information and choose the setup you want.
- 5 Save your profile to update your device.

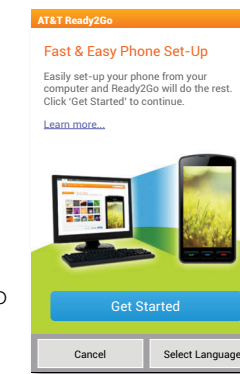

## Home Screen & Apps

Start from the home screen, to explore apps and more.

- **Screen lock:** To unlock the screen, touch and flick to . To lock the screen, press Power/Sleep .
- **Status bar & notifications:** Icons at the top of your screen show notifications (like a new email or calendar reminder) on the left, and phone status on the right. Flick the bar down and touch a notification to open it, or flick the notification to the right to remove it.
- **App & widget list:** To show all of the apps and widgets, touch Apps . Flick left to scroll through the apps. Touch **WIDGETS** at the top to show widgets.
- **Circles Widget:** Interact with these circles to see useful information. Flick the time circle for notifications, the weather circle to add locations, and the data/battery circle to show battery remaining or data usage (accurate within the last 24 hours—visit [att.com/Wireless](http://att.com/Wireless) for details).

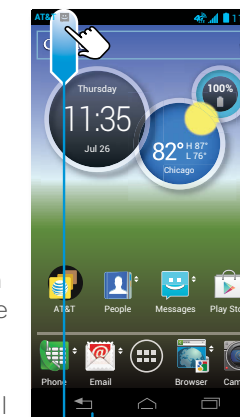

- App & widget list
- Back
- Home screen
- Recent apps
- Status & notifications

## More Information

### On the Web

- Interactive web tutorials are available at [att.com/Tutorials](http://att.com/Tutorials). Select Manufacturer: **Motorola** and Model: **ATRIX HD** from the drop-down menus.
- Detailed support information including device specifications, user manual, troubleshooting, user forums and knowledgebase articles are available at [att.com/DeviceSupport](http://att.com/DeviceSupport).
- For information about your wireless account, service plan or network, visit [att.com/Wireless](http://att.com/Wireless).
- Learn about the importance of adding a password on your device to protect your privacy as well as how to report a lost or stolen phone here: [att.com/stolenphone](http://att.com/stolenphone).

### On the Phone

- Call AT&T Customer Care at 1-800-331-0500.
- Dial 611 from any AT&T device for assistance with your service or device.

### Find Accessories

Accessories for your smartphone are available at [att.com/WirelessAccessories](http://att.com/WirelessAccessories) or visit your local AT&T store.

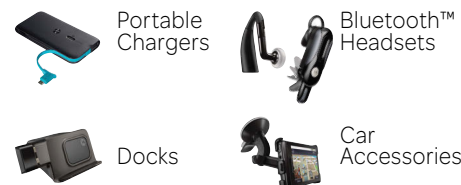

## Control & Customize

Touch, hold, drag, or flick to open shortcuts, widgets, menus, and more.

- **Touch:** Choose an icon or option.
- **Touch & hold:** Move items on the home screen.
- **Wallpaper:** To change your wallpaper, touch and hold an empty spot on the home screen.
- **Widgets & apps:** To add an app shortcut or widget to your home screen, touch Apps , touch and hold the app or widget, then drag it to one of your home screen pages.
- **Pages:** To show or add other pages of shortcuts and widgets, flick the home screen left. To delete pages from your home screen, touch Home , touch and hold a page, then drag it up to **Remove**.
- **Ringtone, display & other settings:** To change settings, flick the status bar down and touch in the top right. Then, choose **Sound, Display**, or other settings.

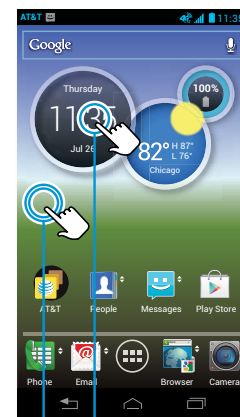

- Open (touch) or move/delete (touch & hold)
- Change wallpaper (touch & hold)

## Smart Actions

Wish your phone could automatically reply to texts when you're driving, silence your ringer during meetings, and conserve your battery when it runs low? It can. **Smart Actions** can automate actions you take on your phone.

**Smart Actions** suggests actions to automate, based on how you use your phone. When you see a suggestion in the status bar, flick the bar down to accept or delete it.

To open actions, touch Apps > **Smart Actions**.

- To create an action, touch **+**.
- To turn an action off or on, open it and touch **OFF** or **ON** at the top.
- To stop **Smart Actions** suggestions, touch Menu > **Settings** and uncheck **Suggestion notifications**.
- For help in **Smart Actions**, touch Menu > **Help**.

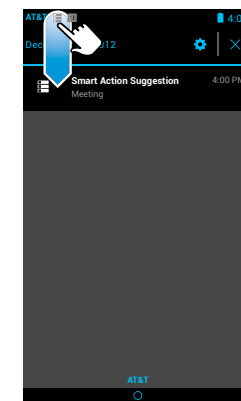

## Calls

Dial numbers, recent calls, or contacts, all from one app.

### Find it: Phone

- **Make a call:** In the dialer, enter a number then touch .
- **During a call:** Your touchscreen goes dark to avoid accidental touches. To wake it up, move it away from your face or press Power .
- **People:** To search your **People**, touch .
- **Voicemail:** A shows in the status bar when you have new voicemail. To hear it, touch **Phone** then touch and hold **1**.

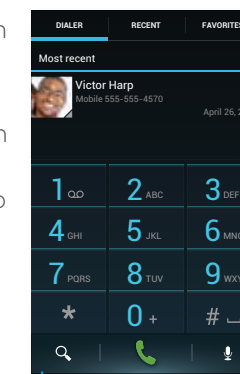

- Search people
- Call
- Voice dial

## Contacts

Combine information from your Google™ contacts and social networks for quick access to everyone.

### Find it: People

- **Create:** Touch **+** below the **People** list.
- **Edit or delete:** Touch and hold a contact, then touch edit or delete (touch and hold icons to show labels).
- **Call, text, or email:** Touch a contact, then touch an option.

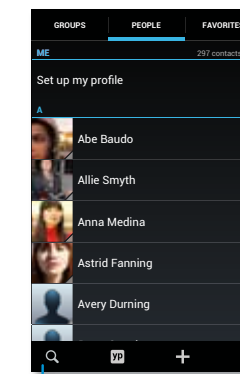

- Search people
- Search businesses
- Add contact
- Settings & more

## Calendar

Show events stored on your phone and in your online calendars, all together in one place.

**Find it:** **Calendar**

- **Change the view:** Touch the date at the top left to choose **Day**, **Week**, **Month**, or **Agenda**. To go to a date, touch Menu > **Go to date**.
- **Add events:** From any view, touch Menu > **New event**, enter event details, then touch **SAVE**.

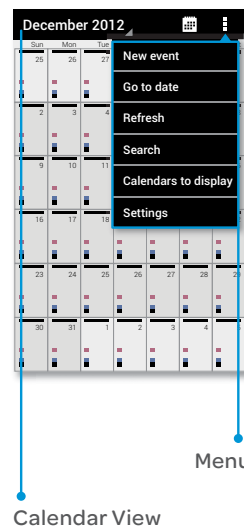

## Text Messages

Stay in touch with messages and pictures.

**Find it:** Apps > **Messages**

- **Create:** Touch above the inbox list.
- **Open:** Touch a conversation to open it.
- **Delete:** Touch and hold a conversation or message, then touch .
- **Attach:** When you're typing a message, touch to attach a picture, video, or other file.
- **Reply to all in text messages:** When you send a text message to multiple people, you can let everyone see the other recipients and reply to all, or hide the other recipients so that replies only go to you. To change this, touch Apps > **Messages** > Menu > **Settings** > **Group message type**.

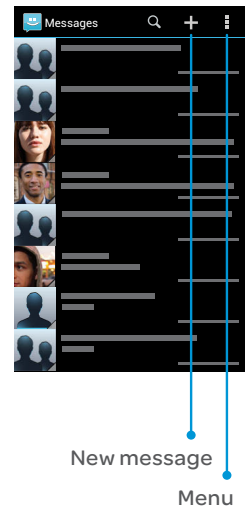

## Email

Check email accounts, and send responses, photos, websites, and more.

**Find it:** **Email**

- **Add email accounts:** To add accounts for **Email**, follow the prompts when you first open the app or touch > **ADD ACCOUNT**, then enter details. For Microsoft® Exchange server work email accounts, enter details from your IT administrator.
- **Change or delete accounts:** To change an account's sync and notifications, or delete it, touch Apps > **Settings** > **Accounts & sync**, touch an account, then change settings or touch Menu > **Remove account**.

**Tip:** To open your Gmail™, touch Apps > **Gmail**.

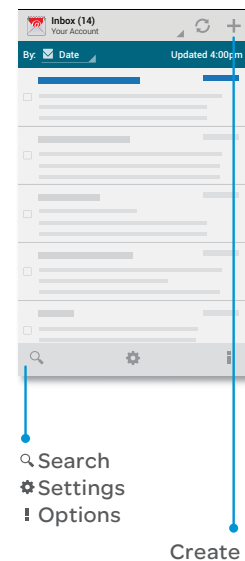

## Browse

Find a webpage, or just explore:

**Find it:** **Browser**

- **Go to a webpage:** In the browser, just touch the address bar at the top of a page and enter an address (you might need to flick back to the top of the page).
- **Create or open bookmarks:** In the browser, open the address bar (flick down), then touch Menu > **Save to bookmarks** or **Bookmarks**.
- **Clear history:** In the browser, touch Menu > **Settings** > **Privacy & security**, then choose history, cache, cookies, and other options.



## Photos & Videos

Capture photos and videos to send them to friends or save them for later.

**Find it:** **Camera**

- **Take a photo:** Open the camera, then touch .
- **Record a video:** Touch in the camera, then touch to start or stop recording.
- **View, share, or delete:** Touch your last photo in the corner of your viewfinder, or touch Apps > **Gallery** and touch a photo. You can choose share, delete, Menu , and more.

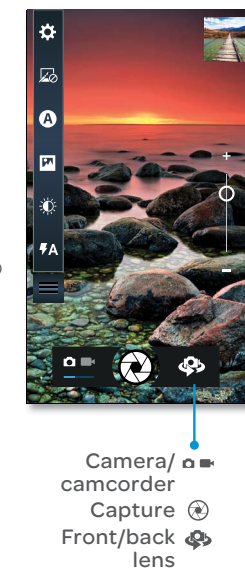

## Connect & Transfer

Connect Wi-Fi networks and Bluetooth® accessories.

**Find it:** Flick the status bar down and touch in the top right

- **Bluetooth® devices:** To connect a Bluetooth headset, keypad, or other device, touch **Bluetooth**.
- **Wi-Fi networks:** To connect, touch **Wi-Fi**.
- **Wi-Fi hotspot:** To make your phone a hotspot, touch **Tethering & Mobile Hotspot**, then check **Mobile Hotspot**. You can change hotspot security.

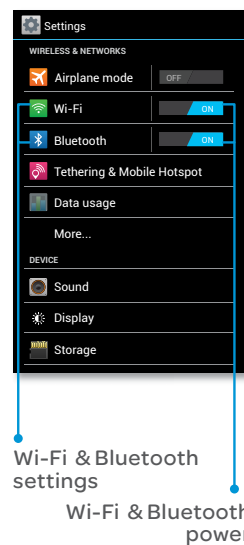

## Download Apps

Google Play™ is a new entertainment hub full of music, movies, books, apps, and games. You can instantly access your content from all your Android devices.

**Find it:** **Play Store**

- **Find:** To search, touch in the top right.
- **Review:** To show details and reviews for an app you found, just touch it.
- **Download:** To download an app you found, touch it to open details and then touch **Download**, or the price, in the top right.
- **Share:** To share an app you found, touch it to open details and then touch at the top.
- **Reinstall:** To show or reinstall apps you downloaded from the Google Play Store app, touch Menu > **My Apps**.
- **Uninstall apps:** Flick the status bar down and touch in the top right, touch > **Apps** > **ALL**, touch an app, then touch **Disable** or **Uninstall** in the top right (if available). **Disable** removes the app from your menu—to **Enable** it, reopen this window and touch **Enable** (disabled apps are at the bottom of the list).

## AT&T Network Notifications

Your 4G LTE wireless device will display one of the following network indicators to let you know which of AT&T's wireless networks you are connected to. A network indicator does not necessarily mean that you will experience any particular upload or download data speeds. Actual speeds depend upon a variety of factors, including the device, network utilization, file characteristics, terrain, etc.

Learn more at:

<http://wireless.att.com/learn/articles-resources/wireless-terms.jsp>, your AT&T Wireless Customer Agreement, Section 3.2 Where and How Does AT&T Service Work?

Connected to AT&T's 4G LTE network.

Connected to AT&T's HSPA+ network. AT&T's HSPA+ network is capable of delivering 4G speeds when combined with enhanced backhaul. Your wireless device cannot distinguish between HSPA+ cell sites combined with enhanced backhaul and those without enhanced backhaul. Enhanced backhaul is available in limited areas. However, availability is increasing with ongoing backhaul deployment. Learn more at [att.com/network](http://att.com/network)

Connected to AT&T's EDGE/2G network.

Limited 4G LTE availability in select markets. LTE is a trademark of ETSI. Learn more about 4G LTE at [att.com/network](http://att.com/network). IMPORTANT INFORMATION: Mobile broadband coverage and other coverage not available in all areas. See coverage map at store for details. Other conditions and restrictions apply. See contract for details.

## AT&T Features & Services

- **myAT&T**—Pay your bill, view wireless voice and data usage, add or remove wireless account features..
  - **AT&T Code Scanner**—Read UPC, QR and Data Matrix barcodes. Scan, Shop, Save.
  - **AT&T Navigator**—Get traffic updates, GPS navigation and turn-by-turn voice directions.
  - **Live TV**—Watch LIVE, on-demand and downloadable mobile TV including ESPN Mobile TV, Fox news and more.
  - **Smart Wi-Fi**—Finds and automatically connects to available hotspots, maximize battery life by only turning Wi-Fi on & off when needed.
  - **AT&T FamilyMap**—Quickly and conveniently locate your family.
- Note:** For more AT&T apps, visit the AT&T section in the Google Play™ Store app.

AT&T Navigator, Live TV and AT&T FamilyMap require a separate subscription and data charges apply. Live TV requires mobile broadband service. Service not available in all areas. Programming subject to blackout restrictions. Download and watch capability available for select content, requires Wi-Fi connection and is available for viewing for limited time periods.

Requires a min DataPro 5GB plan. Devices connected to your Mobile Hotspot use data from your plan. Coverage charges apply if the included monthly data allowance is exceeded. Performance may vary depending on the number of devices connected and other factors.

**SAR** This product meets the applicable limit for exposure to radio waves (known as SAR) of 1.6 W/kg (FCC & IC). The limits and guidelines include a substantial safety margin designed to assure the safety of all persons, regardless of age and health. The highest SAR values measured for this device are listed in the regulatory information packaged with your product. Certain features, services and applications are network dependent and may not be available in all areas; additional terms, conditions and/or charges may apply for voice, messaging, data, and other services. Contact AT&T Mobility for details. All features, functionality, and other product specifications, as well as the information contained in this guide, are based upon the latest available information and believed to be accurate at the time of printing. Motorola reserves the right to change or modify any information or specifications without notice or obligation. **Note: The images in this guide are examples only.** MOTOROLA and the Stylized M Logo are trademarks or registered trademarks of Motorola Trademark Holdings, LLC. Google, the Google logo, Gmail, Google Play, Google Calendar, Android, and other marks are trademarks of Google Inc. AT&T, the AT&T logo and all other AT&T marks contained herein are trademarks of AT&T Intellectual Property and/or AT&T affiliated companies. All other product or service names are the property of their respective owners. Portions ©2012 Motorola, Mobility Inc. Portions ©2012 AT&T Intellectual Property. All rights reserved. **Caution:** Motorola does not take responsibility for changes/modification to the transceiver. Product ID: MOTOROLA ATRIX™ HD (Model MB886) Manual Number: 68016489001-A