

## **Nokia C2-03/C2-06 User Guide**

<b>Contents</b>	
<b>Safety</b>	<b>4</b>
<b>Get started</b>	<b>5</b>
Your dual SIM phone	5
Keys and parts	5
Insert a SIM card and battery	6
Insert a second SIM card	7
Insert a memory card	8
Charge the battery	9
Attach a strap	10
Switch the phone on or off	10
GSM antenna	11
<b>Basic use</b>	<b>11</b>
Access codes	11
Set which SIM card to use	12
Lock or unlock the keys and screen	12
Touch screen actions	13
Swipe to open an application or activate a feature	14
Indicators	14
Copy contacts or messages from your old phone	15
Change the volume of a call, song, or video	15
<b>Calls</b>	<b>16</b>
Make a call	16
Call the last dialled number	16
View your missed calls	16
<b>Contacts</b>	<b>17</b>
Save a name and phone number	17
Use speed dial	17
<b>Write text</b>	<b>17</b>
Switch between text input modes	17
Write using traditional text input	18
Use predictive text input	19
<b>Messaging</b>	<b>19</b>
Send a message	19
Retrieve a multimedia message	20
Listen to voice messages	21
Send an audio message	21
<b>Personalise your phone</b>	<b>21</b>
About the home screen	21
Personalise the home screen	21
Personalise your phone tones	22
<b>Time management</b>	<b>23</b>
Change the time and date	23
Set an alarm	23
Add an appointment	24
<b>Connectivity</b>	<b>24</b>
Bluetooth	24
USB data cable	25
<b>Music and audio</b>	<b>25</b>
FM radio	25
Media player	27
<b>Pictures and videos</b>	<b>27</b>
Take a picture	27
Record a video	28
Send a picture or video	28
<b>Web</b>	<b>28</b>
About the web browser	28
Browse the web	29
Fit a web page to your phone display	29
Add a bookmark	30
Clear your browsing history	30
<b>Keep in touch with your online friends</b>	<b>30</b>
About Communities	30
<b>Mail and chat</b>	<b>31</b>
About Mail	31

Send a mail	31
Read and reply to mail	31
About Chat	32
Chat with your friends	32

**Maps 32**

About Maps	32
View your current location on the map	33
Find a place	33
Share your location or a place	33
Create a walking route	34

**Nokia's Ovi services 34**

Availability and costs of Nokia's Ovi services	34
Access Nokia's Ovi services	34

**Find help 35**

Support	35
Subscribe to the Tips and Offers service	35
Keep your phone up to date	35

**Protect the environment 37**

Save energy	37
Recycle	38

**Product and safety information 38****Index 45**

## Safety

Read these simple guidelines. Not following them may be dangerous or illegal. For further information, read the complete user guide.

### SWITCH OFF IN RESTRICTED AREAS



Switch the device off when mobile phone use is not allowed or when it may cause interference or danger, for example, in aircraft, in hospitals or near medical equipment, fuel, chemicals, or blasting areas. Obey all instructions in restricted areas.

### ROAD SAFETY COMES FIRST



Obey all local laws. Always keep your hands free to operate the vehicle while driving. Your first consideration while driving should be road safety.

### INTERFERENCE



All wireless devices may be susceptible to interference, which could affect performance.

### QUALIFIED SERVICE



Only qualified personnel may install or repair this product.

### KEEP YOUR DEVICE DRY



Your device is not water-resistant. Keep it dry.

### PROTECT YOUR HEARING



Listen to a headset at a moderate level, and do not hold the device near your ear when the loudspeaker is in use.

## Get started

### Your dual SIM phone

You can insert two SIM cards.

#### Some benefits of a dual SIM phone

- You can make savings when you use services from different service providers.
- Use one phone number for personal calls and another for work, but carry only one phone.
- Avoid network coverage variation between service providers.

Both SIM cards are available at the same time when the device is not being used, but while one SIM card is active, for example, making a call, the other is unavailable.

If you only have one SIM card, insert the card into the SIM1 card holder. Some features and services may only be available when using the SIM card in the SIM1 card holder. If there is a SIM card only in the SIM2 card holder, you can only make emergency calls.

A GPRS connection cannot be open in the background. If an application is using a GPRS connection, and you return to the home screen or switch to another application, menu, or other view, the connection is automatically closed.

### Keys and parts

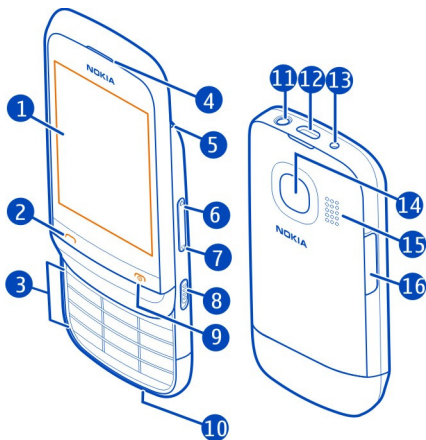

1 Display

- 2 Call key
- 3 Keypad
- 4 Earpiece
- 5 Wrist strap hole
- 6 Volume up/Zoom in key
- 7 Volume down/Zoom out key
- 8 Key lock switch
- 9 End/Power key
- 10 Microphone
- 11 Nokia AV Connector (3.5 mm)
- 12 Micro-USB connector
- 13 Charger connector
- 14 Camera lens. Before using the camera, remove the protective tape from the lens.
- 15 Loudspeaker
- 16 SIM card slot (SIM 2)

To switch between SIM cards, on the home screen, press and hold \*.

### Insert a SIM card and battery

**!** **Note:** Switch the device off and disconnect the charger and any other device before removing any covers. Avoid touching electronic components while changing any covers. Always store and use the device with any covers attached.

**!** **Important:** This device is designed to be used with a standard SIM card (see figure) only. Use of incompatible SIM cards may damage the card or the device, and may corrupt data stored on the card. Please consult your mobile operator for the use of a SIM card that has a mini-UICC cutout.



**!** **Important:** To prevent damage to the SIM card, always remove the battery before you insert or remove the card.

This phone is intended for use with a BL-5C battery. Always use original Nokia batteries.

If you only have one SIM card, insert the card into the internal SIM card holder.

The SIM card and its contacts can be easily damaged by scratches or bending, so be careful when handling, inserting, or removing the card.

- 1 Place your finger in the recess at the top of the phone, and carefully lift and remove the back cover (1). If the battery is inserted, lift it out (2).

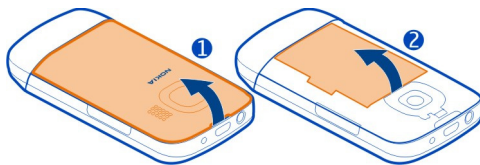

- 2 Open the SIM card holder (3), and insert or remove the SIM card (4 or 5). Make sure the contact area of the card is facing down.



- 3 Line up the contacts of the battery and the battery compartment, and insert the battery (6). To replace the back cover, direct the bottom locking catches toward their slots (7), and press down until the cover locks into place (8).



### Insert a second SIM card

Have a second SIM card, but want to keep using your main SIM card? You can insert or remove a second SIM card without switching the phone off.

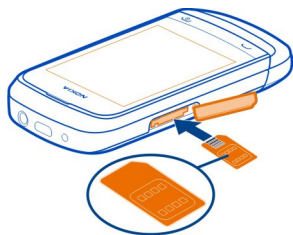

- 1 Open the cover of the external SIM card slot, marked with **SIM 2**.
- 2 Make sure the contact area of the card is facing up, and insert the SIM card. Push the card in, until it locks into place. Close the cover.

### Remove the second SIM card

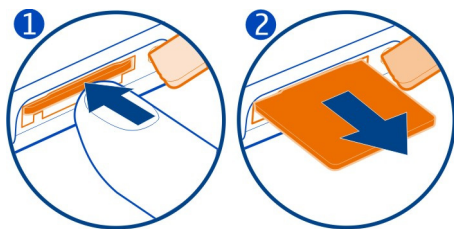

### Insert a memory card

Use only compatible memory cards approved by Nokia for use with this device. Incompatible cards may damage the card and the device and corrupt data stored on the card.

Your phone supports memory cards with a capacity of up to 32 GB.



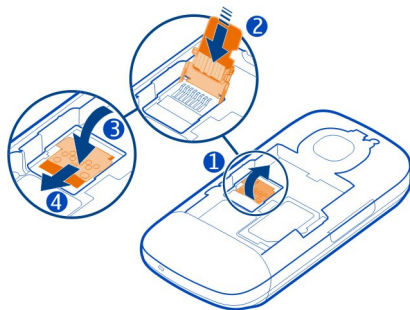

- 1 Switch the phone off, and remove the back cover and battery.
- 2 To release the memory card holder, slide the holder in the direction indicated by the arrow on the holder. Lift the memory card holder (1).
- 3 Insert a compatible memory card. Make sure the contact area of the card is facing down (2).
- 4 Lower the memory card holder (3).
- 5 To lock the memory card holder, slide the holder to its original position (4).

### Remove the memory card

- 1 Switch the phone off.
- 2 Remove the back cover and battery.
- 3 To release the memory card holder, slide the holder in the direction indicated by the arrow on the holder. Lift the memory card holder, and remove the memory card.

### Charge the battery

Your battery has been partially charged at the factory, but you may need to recharge it before you can switch on your phone for the first time. If the phone indicates a low charge, do the following:

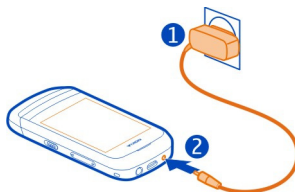

## 10 Get started

---

- 1 Connect the charger to a wall outlet.
- 2 Connect the charger to the phone.
- 3 When the phone indicates a full charge, disconnect the charger from the phone, then from the wall outlet.

You do not need to charge the battery for a specific length of time, and you can use the phone while it is charging.

If the battery is completely discharged, it may take several minutes before the charging indicator is displayed or before any calls can be made.

If the battery has not been used for a long time, to begin charging, you may need to connect the charger, then disconnect and reconnect it.

### Attach a strap



Straps may be available separately.

### Switch the phone on or off

Press and hold the power key .

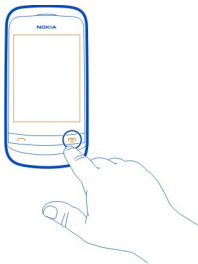

You may be prompted to get the configuration settings from your network service provider. For more information on this network service, contact your network service provider.

## GSM antenna



The antenna area is highlighted.

Avoid touching the antenna area while the antenna is in use. Contact with antennas affects the communication quality and may reduce battery life due to higher power level during operation.

## Basic use

### Access codes

<p>PIN or PIN2 code (4-8 digits)</p>	<p>These protect your SIM card against unauthorised use or are required to access some features.</p> <p>You can set your device to ask for the PIN code when you switch it on.</p> <p>If not supplied with your SIM card or you forget the codes, contact your service provider.</p> <p>If you enter the code incorrectly three times in a row, you need to unblock the code with the PUK or PUK2 code.</p>
<p>PUK or PUK2 code (8 digits)</p>	<p>These are required to unblock a PIN or PIN2 code.</p> <p>If not supplied with your SIM card, contact your service provider.</p>

IMEI number (15 digits)	This is used to identify valid devices in the network. The number can also be used to block, for example, stolen devices.  To view your IMEI number, dial <b>*#06#</b> .
Lock code (security code) (min. 4 digits or characters)	This helps you protect your device against unauthorised use.  You can set your device to ask for the lock code that you define. The default lock code is 12345.  Keep the code secret and in a safe place, separate from your device.  If you forget the code and your device is locked, your device will require service. Additional charges may apply, and all the personal data in your device may be deleted.  For more information, contact a Nokia Care Point or your device dealer.

### Set which SIM card to use

You can set which SIM card to use for outgoing calls, messages, and mobile data. If you name your SIM cards, you can see at a glance which is, for example, for work and which is for personal use.

Select **Menu > SIM manager**.

Select from the following:

**Ask every time** — Select the SIM card to use every time you make a call, send a message, or transfer mobile data.

**SIM1** — Use the SIM card in the internal SIM card holder as the default SIM card to make a call, send a message, or transfer mobile data.

**SIM2** — Use the SIM card in the external SIM card slot as the default SIM card to make a call, send a message, or transfer mobile data.

### Rename a SIM card

Select and hold **SIM1** or **SIM2**, and from the pop-up menu, select **Rename**.

**Tip:** To open the SIM manager from the home screen, press and hold **\***.

### Lock or unlock the keys and screen

To avoid accidentally making a call when your phone is in your pocket or bag, lock the keys and screen of your phone.

Slide the key lock switch.

**Tip:** If the key lock switch is out of reach, to unlock the keys and screen, press the end key, and select **Unlock**.

### Touch screen actions

To interact with the touch screen user interface, tap or tap and hold the touch screen.

#### Open an application or other screen element

Tap the application or element.

#### Access item-specific options

Tap and hold the item. A pop-up menu with available options opens.

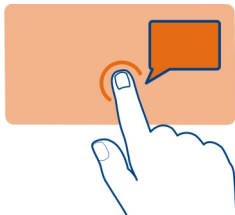

#### Scroll in a list or menu

Place your finger on the screen, slide it quickly up or down the screen, and then lift your finger. The content of the screen scrolls with the speed and direction it had at the moment of release. To select an item from a scrolling list and to stop the movement, tap the item.



#### Swipe

Place a finger on the screen, and steadily slide your finger in the desired direction.



### Swipe to open an application or activate a feature

You can open applications or activate features when you swipe left or right on the home screen.

### Assign a function or feature to a swipe action

Select **Menu > Settings > My shortcuts > Swipe gesture**, and select the swipe direction and desired function or feature.

### Indicators

	You have unread messages sent to SIM1.
	You have unread messages sent to SIM2.
	You have unread messages sent to SIM1 and SIM2.
	You have unsent, cancelled, or failed messages in SIM1.
	You have unsent, cancelled, or failed messages in SIM2.
	You have unsent, cancelled, or failed messages in SIM1 and SIM2.
	The keypad is locked.
	The phone does not ring for incoming calls or text messages.
	An alarm is set.
or	The phone is registered to the GPRS or EGPRS network using SIM1.
or	The phone is registered to the GPRS or EGPRS network using SIM2.
	A GPRS or EGPRS connection from SIM1 is open.
	A GPRS or EGPRS connection from SIM2 is open.
	The GPRS or EGPRS connection from SIM1 is suspended (on hold) .
	The GPRS or EGPRS connection from SIM2 is suspended (on hold).
	Bluetooth is activated.
	All incoming calls to SIM1 are diverted to another number.
	All incoming calls to SIM 2 are diverted to another number.
	All incoming calls to SIM1 and SIM2 are diverted to another number.



The currently active profile is timed.

A headset is connected to the phone.

The phone is connected to another device, using a USB data cable.

### Copy contacts or messages from your old phone

Want to copy your content from your previous compatible Nokia phone and start using your new phone quickly? You can copy, for example, contacts, calendar entries, and messages to your new phone, free of charge.



- 1 Activate Bluetooth in both phones.  
Select **Menu > Settings > Connectivity > Bluetooth**.
- 2 Select **Menu > Settings > Sync & backup**.
- 3 Select **Phone switch > Copy to this**.
- 4 Select the content to copy and **Done**.
- 5 Select your previous phone from the list.
- 6 If the other phone requires a passcode, enter the passcode. The passcode, which you can define yourself, must be entered in both phones. The passcode in some phones is fixed. For details, see the user guide of the other phone.  
The passcode is valid only for the current connection.
- 7 If prompted, allow connection and copying requests.

### Change the volume of a call, song, or video

Use the volume keys.

The built-in loudspeaker allows you to speak and listen from a short distance without having to hold the phone to your ear.

#### Activate the loudspeaker during a call

Select **Loudsp..**

### Calls

#### Make a call

- 1 Open the slide.
- 2 On the home screen, enter the phone number.  
To delete a number, select **Clear**.  
For international calls, select \* twice for the + character (which replaces the international access code), and enter the country code, area code (omit the leading zero if necessary), and phone number.
- 3 Press the call key.
- 4 If prompted, select the SIM card to use.
- 5 To end the call, press the end key.

**Tip:** If the slide is closed and  is displayed on the home screen, to use the virtual keypad to enter the phone number, select .

When you receive a call, the SIM card in use is indicated.

#### Call the last dialed number

Trying to call someone, but they are not answering? It is easy to call them again.

- 1 On the home screen, press the call key.
- 2 Go to the number, and press the call key.  
If prompted, select the SIM card to use.

#### View your missed calls

Want to see who made the call you missed?

On the home screen, select **View**. The caller's name is displayed, if stored in the contacts list.

Missed and received calls are logged only if supported by the network, and the phone is switched on and within the network service area.

#### Call back the contact or number

Go to the contact or number, and press the call key.

#### View the missed calls later

Select **Menu > Contacts > Log and Missed calls**.



## Contacts

### Save a name and phone number

Select **Menu** > **Contacts**.

Select **Add new**, and enter the number and name.

If prompted, select where to save the contact.

### Add or edit the details of a contact

- 1 Select **Names** and a contact.
- 2 Select **Options** > **Add detail**.

**Tip:** To add a ringtone or picture for a contact, select the contact and **Options** > **Add detail** > **Multimedia**.

### Use speed dial

You can quickly call your friends and family when you assign your most-used phone numbers to the number keys of your phone.

You can only use speed dials for the contacts stored on your phone or on the SIM card in the internal SIM card holder.

Select **Menu** > **Contacts** > **Speed dials**.

### Assign a phone number to a number key

- 1 Select a number key. 1 is reserved for the voice mailbox.
- 2 Enter a number or search for a contact.

### Remove or change a phone number assigned to a number key

Select and hold the number key, and from the pop-up menu, select **Delete** or **Change**.

### Make a call

On the home screen, press and hold a number key.

### Deactivate speed dialling

Select **Menu** > **Settings and Call** > **Speed dialling**.

## Write text

### Switch between text input modes

When writing text, you can use traditional  or predictive  text input.

AbC abC and ABC indicate the character cases. 123 indicates that number mode is activated.

### Activate or deactivate predictive text input mode

Select **Options** > **Prediction** > **Prediction on** or **Prediction off**. Not all languages are supported by predictive text input.

### Switch between character cases

Press #.

### Activate number mode

Press and hold #, and select **Number mode**. To return to letter mode, press and hold #.

**Tip:** To quickly enter an individual number, press and hold the number key.

### Set the writing language

Select **Options** > **Writing language**.

**Tip:** To activate number mode, activate or deactivate predictive text input mode, or set the writing language, you can also press and hold #, and select the appropriate option.

### Write using traditional text input

- 1 Press a number key (2-9) repeatedly, until the desired character is displayed.
- 2 Insert the next character. If it is located on the same key, wait until the cursor is displayed, or move the cursor forward.

The available characters depend on the selected writing language.

### Move the cursor

Select ◀ or ▶, or tap where you want to place the cursor.

### Insert a common punctuation mark

Press 1 repeatedly.

### Insert a special character

Select ?!£ and the desired character.

### Insert a space

Press 0.

**Use predictive text input****Write using predictive text input**

The built-in dictionary suggests words as you select the number keys.

- 1 Select each number key (2–9) once for each character.
- 2 To find the desired word, select \* repeatedly.
- 3 To confirm the word, select ►.

**Add a missing word to the dictionary**

If ? is displayed when you enter a word using predictive text input, the word is not in the dictionary. You can add it to the built-in dictionary.

- 1 Select **Spell**.
- 2 Write the word using traditional text input.
- 3 Select **Save**.

**Write a compound word**

- 1 Write the first part of the word. To confirm the word, move the cursor forward.
- 2 Write the next part of the word, and confirm again.

**Messaging****Send a message**

Keep in touch with your family and friends with text and multimedia messages. You can attach your pictures, videos, and business cards to your message.

Select **Menu** > **Messaging**.

- 1 Select **Create message**.
- 2 To add an attachment, select **Options** > **Insert object**.
- 3 Write your message, and select **Continue**.
- 4 To enter a phone number or mail address manually, select **Number or mail**. Enter a phone number, or select **Mail**, and enter a mail address.
- 5 Select **Send**.  
If prompted, select the SIM card to use.

**Tip:** To insert a special character or smiley, select **Options** > **Insert symbol**.

Sending a message with an attachment may be more expensive than sending a normal text message. For more information, contact your service provider.

You can send text messages that are longer than the character limit for a single message. Longer messages are sent as two or more messages. Your service provider may charge accordingly.

Characters with accents, other marks, or some language options, take more space, limiting the number of characters that can be sent in a single message.

If the item you insert in a multimedia message is too large for the network, the device may automatically reduce the size.

Only compatible devices can receive and display multimedia messages. Messages may look different in different devices.

### Retrieve a multimedia message

To check your current settings of multimedia message retrieval, select **Menu > Messaging and Msg. settings > MMS > SIM1** or **SIM2**, and select **MMS reception**.

**Tip:** Outside your home network, sending and receiving multimedia messages may cost you more. To save costs, you can stop your phone from retrieving multimedia messages automatically. For more information on the costs, contact your network service provider.

Using services or downloading content may cause transfer of large amounts of data, which may result in data traffic costs.

### Modify settings for multimedia message retrieval

- 1 Select **Menu > Messaging and Msg. settings > MMS**.
- 2 Select **SIM1** or **SIM2**. The multimedia message settings apply to both SIM cards.
- 3 Select **MMS reception** and from the following:

**Automatic** — Multimedia messages are always retrieved automatically.

**Manual** — You receive notifications about multimedia messages that you have received in your messaging centre, and you can retrieve the multimedia messages manually.

**Off** — Multimedia message retrieval is deactivated. You do not get notifications about multimedia messages.

If you select **MMS reception > Manual**, you can retrieve multimedia messages manually.

### Retrieve a multimedia message manually

- 1 Select **Menu > Messaging > Inbox**.
- 2 Open the multimedia message notification, and select **Retrieve**. The multimedia message is downloaded to your phone.

### Listen to voice messages

When you can't answer, you can divert calls to your voice mailbox and listen to your messages later.

You may need a voice mailbox subscription. For more information on this network service, contact your service provider.



You can only use the voice mailbox with the SIM card in the internal SIM card holder.

- 1 Select **Menu** > **Messaging** > **Voice messages** and **Voice mailbox no..**
- 2 Enter your voice mailbox number, and select **OK**.
- 3 To call your voice mailbox, on the home screen, press and hold **1**.

### Send an audio message

Don't have time to write a text message? Record and send an audio message instead.

Select **Menu** > **Messaging**.

- 1 Select **Other messages** > **Audio message**.
- 2 To record your message, select .
- 3 To stop recording, select .
- 4 Select **Continue** and a contact.

## Personalise your phone

### About the home screen

On the home screen, you can:

- See notifications of missed calls and received messages
- Open your favourite applications
- Control applications, such as the radio
- Add shortcuts for different features, such as writing a message
- View your favourite contacts, and quickly call or send messages to them

### Personalise the home screen

Want to see your favourite landscape or pictures of your family in the background of the home screen? You can change this wallpaper, and rearrange items on the home screen, to personalise it to your liking.

#### Change the wallpaper

- 1 Select **Menu** > **Settings** and **Display** > **Wallpaper**.
- 2 Select a folder and a picture.

You can also take a picture with your phone camera, and use that picture.

**Tip:** Download more wallpapers from Ovi Store.

### Add an application or shortcut

- 1 Tap and hold the home screen, and from the pop-up menu, select **Personalise view**.
- 2 Select the bar, an item from the list, and **Back**.

### Change a shortcut

- 1 Tap and hold the shortcut you want to change, and from the pop-up menu, select **Change shortcut**.
- 2 Select an item from the list and **Back**.

**Tip:** To remove an application or shortcut bar from the home screen, replace it with another one, or select (**empty**).

**Tip:** To increase the font size in the Messaging and Contacts applications, when browsing the web, or in the main menu, select **Menu > Settings and Display > Font size**.

## Personalise your phone tones

You can personalise the ringtones and key and warning tones for each profile.

Select **Menu > Settings and Tones**.



### Change the ringtone

Select **Ringtone:** and a ringtone.





**Tip:** Download more ringtones from Nokia's Ovi Store. To learn more about Ovi Store, go to [www.ovi.com](http://www.ovi.com).

After selecting a ringtone, you can mark a section of the ringtone, and set the section as your ringtone. The original ringtone or sound clip is not copied or modified. Preset ringtones cannot be modified, and not all formats of ringtones are supported.

### Mark the section to use

- 1 Select a ringtone. When prompted, select **Yes**.
- 2 Drag the start marker  to the start point.
- 3 Drag the end marker  to the end point.  
When a marker is moved to a new point, the selection plays.
- 4 To manually play the selection, select **Play**.
- 5 Select **Done**.



**Tip:** To fine-tune the start and end points of the selection, select  or , and select and hold  or .

### Change the volume of the keypad tones

Select **Keypad tones**, and drag the volume bar.

## Time management

### Change the time and date

Select **Menu** > **Settings** and **Date and time**.

### Change the time zone when travelling

- 1 Select **Date & time settings** > **Time zone**.
- 2 Select the time zone of your location.
- 3 Select **Save**.

The time and date are set according to the time zone. This makes sure that your phone displays the correct sending time of received text or multimedia messages.

For example, GMT -5 denotes the time zone for New York (USA), 5 hours west of Greenwich, London (UK).

### Set an alarm

You can use your phone as an alarm clock.

Select **Menu** > **Applications** > **Alarm clock**.

- 1 Set the alarm time.
- 2 Select  to set the alarm.
- 3 To set the alarm to sound, for example, at the same time every day, select **Settings** > **Alarm repeat** > **On** and the days.

### Add an appointment

Save your important appointments to your calendar as meeting entries.

Select **Menu > Calendar**.

- 1 Go to the desired date, and select **Options > Add new entry**.
- 2 Select the entry type field **Meeting**, and fill in the fields.

## Connectivity

### Bluetooth

#### About Bluetooth connectivity

Select **Menu > Settings > Connectivity > Bluetooth**.

You can connect wirelessly to other compatible devices, such as phones, computers, headsets, and car kits.

You can use the connection to send items from your phone, copy files from your compatible PC, and print files with a compatible printer.

Since devices with Bluetooth wireless technology communicate using radio waves, they do not need to be in direct line-of-sight. However, they must be within 10 metres (33 feet) of each other, although the connection may be subject to interference from obstructions such as walls or from other electronic devices.

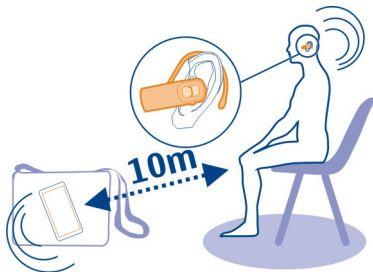

When your phone is locked, only connections to authorised devices are possible.

**Tip:** To access Bluetooth settings from the home screen, add a shortcut to the shortcut widget.

**!** **Note:** There may be restrictions on the use of Bluetooth technology in some countries. For example, in France, you are only allowed to use Bluetooth technology indoors. After 1 July 2012, the restriction on outdoor usage of Bluetooth technology of



this product in France is withdrawn by the EU. For more information, contact your local authorities.

### Send a picture or other content to another device using Bluetooth

Use Bluetooth to send pictures, videos, business cards, and other content created by you to your computer or a friend's compatible phone or device.

- 1 Select and hold the item to send, and from the pop-up menu, select **Send > Via Bluetooth**.
- 2 Select the device to connect to. If the desired device is not displayed, to search for it, select **Options > New search**. Bluetooth devices within range are displayed.
- 3 If the other device requires a passcode, enter the passcode. The passcode, which you can define yourself, must be entered in both devices. The passcode in some devices is fixed. For details, see the user guide of the device.  
The passcode is valid only for the current connection.

The available options may vary.

### USB data cable

#### Copy content between your phone and a computer

You can use a USB data cable to copy your pictures and other content between your phone and a compatible computer.

- 1 Use a compatible USB cable to connect your phone to a computer.
- 2 Select from the following modes:
  - Nokia Ovi Suite** — Nokia Ovi Suite is installed on your computer.
  - Media transfer** — Nokia Ovi Suite is not installed on your computer. If you want to connect your phone to a home entertainment system or printer, use this mode.
  - Mass storage** — Nokia Ovi Suite is not installed on your computer. The phone is displayed as a portable device on your computer. If you want to connect your phone to other devices, such as a home or car stereo, use this mode.
- 3 To copy the content, use the file manager of the computer.  
To copy your contacts, music files, videos, or pictures, use Nokia Ovi Suite.

## Music and audio

### FM radio

#### About the FM radio

Select **Menu > Music > Radio**.

You can listen to FM radio stations using your phone - just connect a headset, and select a station.

To listen to the radio, you need to connect a compatible headset to the device. The headset acts as an antenna.



### **Listen to the radio**

Select **Menu** > **Music** > **Radio**.

### **Change the volume**

Use the volume keys.

### **Close the radio**

Press and hold the end key.

### **Set the radio to play in the background**

Select **Options** > **Play in backgr.**.

### **Close the radio when it is playing in the background**

Press and hold the end key.

### **Find and save radio stations**

Search for your favourite radio stations, and save them, so you can easily listen to them later.

Select **Menu** > **Music** > **Radio**.

### **Search for the next available station**

Select and hold **⏮** or **⏭**.

### **Save a station**

Select **Options** > **Save station**.

**Automatically search for radio stations**

Select **Options** > **Search all stat..** For best results, search when outdoors or near a window.

**Switch to a saved station**

Select  or .

**Rename a station**

- 1 Select **Options** > **Stations**.
- 2 Select and hold the station, and from the pop-up menu, select **Rename**.

**Tip:** To access a station directly from the saved station list, press the number key that corresponds to the number of the station.

**Media player****Play a song**

Play music stored in the phone memory or on the memory card.

Select **Menu** > **Music** > **My music** and **All songs**.

- 1 Select a song.
- 2 To pause playing, select ; to resume, select .

**Play a video**

Play videos stored in the phone memory or on the memory card.

Select **Menu** > **Music** > **My music** and **Videos**.

- 1 Select a video.
- 2 To pause playback, select ; to resume, select .

**Pictures and videos****Take a picture**

- 1 Select **Menu** > **Photos** > **Camera**.
  - 2 To zoom in or out, use the volume keys.
  - 3 Select .
- The pictures are saved in **Menu** > **Photos** > **My photos**.



**Close the camera**

Press the end key.

**Record a video**

Besides taking pictures with your phone, you can also capture your special moments as videos.

Select **Menu > Photos > Video camera.**

- 1 To switch from image mode to video mode, if necessary, select  > **Video c..**
- 2 To start recording, select .  
To zoom in or out, use the volume keys.
- 3 To stop the recording, select .

Videos are saved in **Menu > Photos > My videos.**

**Close the camera**

Press the end key.

**Send a picture or video**

Want to share your pictures and videos with friends and family? Send a multimedia message or send a picture using Bluetooth.

Select **Menu > Applications > Gallery.**

**Send a picture**

- 1 Select the folder containing the picture.
- 2 Select and hold the picture to send.  
To send more than one picture, select **Options > Mark**, and mark the desired pictures.
- 3 Select **Send** or **Options > Send marked** and the desired sending method.

**Send a video**

- 1 Select the folder containing the video.
- 2 Select **Options > Mark**, and mark the video. You can mark several videos to send.
- 3 Select **Options > Send marked** and the desired sending method.

**Web****About the web browser**

Select **Menu > Internet.**

You can view web pages on the internet with the web browser on your phone.

To browse the web, you must be connected to the internet.

If prompted, select the SIM card to use.

For the availability of these services, pricing, and instructions, contact your network service provider.

You may receive the configuration settings required for browsing as a configuration message from your network service provider.

Music and videos cannot be streamed in the phone web browser.

## **Browse the web**

Select **Menu** > **Internet**.

### **View your browsing history, featured sites, or your bookmarks**

To switch between the History, Featured, and Favourites tabs, swipe left or right.

### **Go to a website**

Select the address bar, and enter the address.

### **Move on the web page**

Drag the page with your finger.

### **Zoom in**

Select the desired section of the web page.

### **Zoom out**

Double-tap the screen.

### **Search the internet**

Select the search field, and enter a search word. If prompted, select your default search engine.

### **Return to a previously visited web page**

Open the History tab, and select the web page.

**Tip:** You can download web apps from Nokia's Ovi Store. When you first open a web app, it is added as a bookmark. To learn more about Ovi Store, go to [www.ovi.com](http://www.ovi.com).





## **Fit a web page to your phone display**

Your web browser can optimise web pages for your phone display. Instead of having to zoom in, the web page is arranged into a single column of larger, readable text and pictures.

Select **Menu** > **Internet**.

Select  > **Tools** > **Column view**.

To quickly go to different sections of a web page, select from the following:

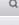
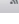
-  /  Go to the previous or next section of the web page.
-  Sign in to the web page.
-  Go to the main section of the web page.
-  Search the web page.
-  Read RSS feeds.

The available options may vary.

This view is not available for web sites designed for mobile use.

### Add a bookmark

If you visit the same websites all the time, add them as bookmarks, so you can easily access them.

Select **Menu** > **Internet**.

While browsing, select  > **Add to favourites**.

### Go to a bookmarked website

Open the **Favourites** tab, and select a bookmark.

### Clear your browsing history

Select **Menu** > **Internet**.

Open the **History** tab, and select  > **Clear history**.

### Clear stored cookies or text saved in web forms

Select  > **Tools** > **Settings** > **Clear cookies** or **Clear auto-fill**.

## Keep in touch with your online friends

### About Communities

Select **Menu** > **Applications** > **Apps and games** > **Communities**, and sign in to your relevant social networking services.

With the **Communities** application, you can enhance your social networking experience. The application may not be available in all regions. When signed in to social networking services, such as Facebook or Twitter, you can do the following:

- See your friends' status updates
- Post your own status update
- Instantly share pictures you take with the camera

Only those features that are supported by the social networking service are available.

Using social networking services requires network support. This may involve the transmission of large amounts of data and related data traffic costs. For information about data transmission charges, contact your service provider.

The social networking services are third party services and not provided by Nokia. Check the privacy settings of the social networking service you are using as you may share information with a large group of people. The terms of use of the social networking service apply to sharing information on that service. Familiarise yourself with the terms of use and the privacy practices of that service.

## Mail and chat

### About Mail

Select **Menu** > **Messaging** > **Mail**.

You can use your phone to read and send mail from your mail accounts from different mail service providers.

Using services or downloading content may cause transfer of large amounts of data, which may result in data traffic costs.

If you do not already have a mail account, you can create a Nokia account, which includes Nokia's Ovi Mail service. For more information, go to [www.ovi.com](http://www.ovi.com). With your Nokia account, you can access all of Nokia's Ovi services.

### Send a mail

Select **Menu** > **Messaging** > **Mail** and a mail account.

- 1 Select **Options** > **Compose new**.
- 2 Enter the recipient's mail address and the subject, and write your message.
- 3 To attach a file, for example, a picture, select **Options** > **Attach** > **From Gallery**.
- 4 To take a picture to attach to the mail, select **Options** > **Attach** > **From Camera**.
- 5 Select **Send**.

### Read and reply to mail

Select **Menu** > **Messaging** > **Mail** and a mail account.

- 1 Select a mail.

2 To reply to or forward a mail, select **Options**.

### About Chat

Select **Menu > Messaging > Chat**.

You can exchange instant messages with your friends. Chat is a network service.

Using services or downloading content may cause transfer of large amounts of data, which may result in data traffic costs.

### Chat with your friends

Select **Menu > Messaging > Chat**.

You can sign in to and chat in several services at the same time. You must separately sign in to each service.

You can have ongoing conversations with several contacts at the same time.

- 1 If several chat services are available, select the desired service.
- 2 Sign in to the service.
- 3 In your contacts list, select the contact you want to chat with.
- 4 Write your message in the text box at the bottom of the display.
- 5 Select **Send**.

## Maps

### About Maps

Your phone comes with the Maps application, and may have a memory card with preloaded maps for your country. Insert the memory card into the phone before using Maps.

You can only use Maps when using the SIM card in the internal SIM card holder.

Select **Menu > Maps**.

You can browse maps of different cities in your country. You can also:

- View your current location
- Plan a route to a nearby place
- Search for a place or specific address, and save it
- Send your location or a place to a friend in a text message

When you browse to an area which is not covered by the maps already downloaded on the memory card, a map for the area is automatically downloaded through the internet.



Downloading maps may involve transmission of large amounts of data through your service provider's network. For information about data transmission charges, contact your service provider.

You can also use the Nokia Ovi Suite application to download maps. To download and install Nokia Ovi Suite on your compatible computer, go to [www.ovi.com](http://www.ovi.com).

Network access may be required to find your current location. You may be prompted to select an internet access point.

Some services may not be available in all countries, and may be provided only in selected languages.

Contents of digital maps may sometimes be inaccurate and incomplete. Never rely solely on the content or the service for essential communications, such as in emergencies.

### **View your current location on the map**

Select **Menu** > **Maps and My position**.

### **Update your current location**

Select **Options** > **Update position**.

### **Save your current location**

Select **Options** > **Save as favourite**.

### **Find a place**

Select **Menu** > **Maps**.

- 1 Select **Search**.
- 2 Enter the name of the place or address.
- 3 Select **Go**. A list of matching places or addresses is displayed.

### **Refine your search**

- 1 Select **Advanced** > **Find place** or **Find address**.
- 2 Define more details for your search, and follow the instructions.

**Tip:** To search from the entire category of places, leave all name fields blank.

**Tip:** If you can't find the place you are looking for, try to search from an online database. Select **Search online for**. Additional charges may apply. For details, contact your service provider.

### **Share your location or a place**

You can send your current location or a place on the map to a friend in a text message.

Select **Menu** > **Maps**.

- 1 Select **My position** or a place on the map and **Options** > **Send this place**.
- 2 Write your message. The address and a link to the location are automatically added.
- 3 Enter the recipient's phone number, or select **Search** and a contact.
- 4 Select **Send**.

When your friend receives the message containing the address details and link, to view the place on the map in the phone web browser, they can select the link.

### Create a walking route

Create a walking route to a nearby place. You can view the route and all the turnings on the map before setting off.

Select **Menu** > **Maps**.

- 1 Select **Plan route**.
- 2 Select **Starting location** and a saved or recent location, a place from the map, or a specific address as the start point of your walking route. To start from your current position, select **My position**.
- 3 Select **Destination** and the end point of the walking route.  
The maximum distance between the start and end points is 10 kilometres, measured in a straight line. Using ferries and some special tunnels for walking routes is restricted.
- 4 Select **Go** > **Start**.
- 5 To cancel the route, select **Options** > **Cancel route**.

## Nokia's Ovi services

### Availability and costs of Nokia's Ovi services

The availability of Nokia's Ovi services may vary by region. Using the services or downloading content may cause transfer of large amounts of data, which may result in data traffic costs. For information about data transmission charges, contact your network service provider.

To learn more about Ovi, go to [www.ovi.com](http://www.ovi.com).

### Access Nokia's Ovi services

Select **Menu** > **Applications** > **Apps and games** and the desired Ovi service.

## Find help

### Support

When you want to learn more about how to use your product or you are unsure how your phone should function, read the user guide thoroughly.

If this does not resolve your issue, do one of the following:

- Reboot your phone. Switch off the phone, and remove the battery. After about a minute, replace the battery, and switch on the phone.
- Update your phone software
- Restore the original factory settings

If your issue remains unsolved, contact Nokia for repair options. Go to [www.nokia.com/repair](http://www.nokia.com/repair). Before sending your phone for repair, always back up your data.

### Subscribe to the Tips and Offers service

Tips and Offers is a convenient service to help you get the most out of your phone, providing you with tips and support messages, as well as updates for your games and applications.

Select **Menu > Applications > Apps and games > Tips and offers**.

Text message charges may apply when you subscribe or unsubscribe. For terms and conditions, see your phone user guide, or go to [www.nokia.com/mynokia](http://www.nokia.com/mynokia).

### Keep your phone up to date

#### Update phone software using your phone

Want to improve the performance of your phone and get application updates and great new features? Update the software regularly to get the most out of your phone. You can also set your phone to automatically check for updates.

#### Warning:

If you install a software update, you cannot use the device, even to make emergency calls, until the installation is completed and the device is restarted.

Using services or downloading content may cause transfer of large amounts of data, which may result in data traffic costs.

You can only update your software when using the SIM card in the internal SIM card holder.

Before starting the update, connect a charger or make sure the device battery has enough power.

Select **Menu > Settings.**



- 1 Select **Device > Device updates.**
- 2 To display the current software version and check whether an update is available, select **Current sw details.**
- 3 To download and install a software update, select **Downl. device sw.** Follow the displayed instructions.
- 4 If the installation was cancelled after the download, select **Install sw update.**

The software update may take several minutes. If there are problems with the installation, contact your network service provider.

### **Check for software updates automatically**

Select **Automatic SW update**, and define how often to check for new software updates.

Your network service provider may send phone software updates over the air directly to your phone. For more information on this network service, contact your network service provider.

### **Update phone software using your PC**

You can use the Nokia Ovi Suite PC application to update your phone software. You need a compatible PC, a high-speed internet connection, and a compatible USB data cable to connect your phone to the PC.

To get more information and to download the Nokia Ovi Suite application, go to [www.ovi.com/suite](http://www.ovi.com/suite).

## Restore original settings

If your phone is not working properly, you can reset some settings to their original values.

- 1 End all calls and connections.
- 2 Select **Menu > Settings and Rest. fact. sett. > Settings only.**
- 3 Enter the security code.

This does not affect documents or files stored on your phone.

After restoring the original settings, your phone switches off and then on again. This may take longer than usual.

## Organise files

You can move, copy, and delete files and folders, or create new folders in your phone memory or on the memory card. If you organise your files into their own folders, it might help you find the files in future.

Select **Menu > Applications > Gallery.**

### Create a new folder

In the folder where you want to create a sub-folder, select **Options > Add folder.**

### Copy or move a file to a folder

Select and hold the file, and from the pop-up menu, select the appropriate option.

**Tip:** You can also play music or videos, or view pictures in Gallery.

## Back up your pictures and other content to a memory card

Want to make sure you will not lose any important files? You can back up your phone memory to a compatible memory card.

Select **Menu > Settings > Sync & backup.**

Select **Create backup.**

### Restore a backup

Select **Restore backup.**

## Protect the environment

### Save energy

You do not need to charge your battery so often if you do the following:

## 38 Product and safety information

- Close applications and data connections, such as your Bluetooth connection, when not in use.
- Deactivate unnecessary sounds, such as touch screen and key tones.

### Recycle



When this phone has reached the end of its working life, all of its materials can be recovered as materials and energy. To guarantee the correct disposal and reuse, Nokia co-operates with its partners through a program called We:recycle. For information on how to recycle your old Nokia products and where to find collection sites, go to [www.nokia.com/werecycle](http://www.nokia.com/werecycle), or call the Nokia Contact Center.

Recycle packaging and user guides at your local recycling scheme.



The crossed-out wheeled-bin symbol on your product, battery, literature, or packaging reminds you that all electrical and electronic products, batteries, and accumulators must be taken to separate collection at the end of their working life. This requirement applies in the European Union. Do not dispose of these products as unsorted municipal waste. For more information on the environmental attributes of your phone, go to [www.nokia.com/ecoprofile](http://www.nokia.com/ecoprofile).

## Product and safety information

### Network services and costs

Your device is approved for use on the (E)GSM 900, 1800 MHz networks.

To use the device, you need a subscription with a service provider.

Using network services and downloading content to your device requires a network connection and may result in data traffic costs. Some product features require support from the network, and you may need to subscribe to them.

### Take care of your device

Handle your device, battery, charger and accessories with care. The following suggestions help you protect your warranty coverage.

- Keep the device dry. Precipitation, humidity, and all types of liquids or moisture can contain minerals that corrode electronic circuits. If your device gets wet, remove the battery, and allow the device to dry.
- Do not use or store the device in dusty or dirty areas. Moving parts and electronic components can be damaged.

- Do not store the device in high temperatures. High temperatures can shorten the life of the device, damage the battery, and warp or melt plastics.
- Do not store the device in cold temperatures. When the device warms to its normal temperature, moisture can form inside the device and damage electronic circuits.
- Do not attempt to open the device other than as instructed in the user guide.
- Unauthorised modifications may damage the device and violate regulations governing radio devices.
- Do not drop, knock, or shake the device. Rough handling can break internal circuit boards and mechanics.
- Only use a soft, clean, dry cloth to clean the surface of the device.
- Do not paint the device. Paint can clog moving parts and prevent proper operation.
- Switch off the device and remove the battery from time to time for optimum performance.
- Keep your device away from magnets or magnetic fields.
- To keep your important data safe, store it in at least two separate places, such as your device, memory card, or computer, or write down important information.

### **Recycle**

Always return your used electronic products, batteries, and packaging materials to dedicated collection points. This way you help prevent uncontrolled waste disposal and promote the recycling of materials. Check how to recycle your Nokia products at [www.nokia.com/recycling](http://www.nokia.com/recycling).

### **About Digital Rights Management**

When using this device, obey all laws and respect local customs, privacy and legitimate rights of others, including copyrights. Copyright protection may prevent you from copying, modifying, or transferring images, music, and other content.

Content owners may use different types of digital rights management (DRM) technologies to protect their intellectual property, including copyrights. This device uses various types of DRM software to access DRM-protected content. With this device you can access content protected with WMDRM 10 and OMA DRM 1.0. If certain DRM software fails to protect the content, content owners may ask that such DRM software's ability to access new DRM-protected content be revoked. Revocation may also prevent renewal of such DRM-protected content already in your device. Revocation of such DRM software does not affect the use of content protected with other types of DRM or the use of non-DRM-protected content.

Digital rights management (DRM) protected content comes with an associated licence that defines your rights to use the content.

If your device has OMA DRM-protected content, to back up both the licences and the content, use the backup feature of Nokia Ovi Suite.

Other transfer methods may not transfer the licences which need to be restored with the content for you to be able to continue the use of OMA DRM-protected content after the device memory is formatted. You may also need to restore the licences in case the files on your device get corrupted.

If your device has WMDRM-protected content, both the licences and the content will be lost if the device memory is formatted. You may also lose the licences and the content if the files on your device get corrupted. Losing the licences or the content may limit your ability to use the same content on your device again. For more information, contact your service provider.

Some licences may be connected to a specific SIM card, and the protected content can be accessed only if the SIM card is inserted in the device.

### **Batteries and chargers**

#### **Battery and charger information**

Your device is intended for use with a BL-5C rechargeable battery. Nokia may make additional battery models available for this device. Always use original Nokia batteries.

This device is intended for use when supplied with power from the following chargers: AC-3. The exact Nokia charger model number may vary depending on the plug type, identified by E, X, AR, U, A, C, K, or B.

## 40 Product and safety information

---

The battery can be charged and discharged hundreds of times, but it will eventually wear out. When the talk and standby times are noticeably shorter than normal, replace the battery.

### Battery safety

Always switch the device off and disconnect the charger before removing the battery. When you unplug a charger or an accessory, hold and pull the plug, not the cord.

When your charger is not in use, unplug it from the electrical plug and the device. Do not leave a fully charged battery connected to a charger, as overcharging may shorten the battery's lifetime. If left unused, a fully charged battery will lose its charge over time.

Always keep the battery between 15°C and 25°C (59°F and 77°F). Extreme temperatures reduce the capacity and lifetime of the battery. A device with a hot or cold battery may not work temporarily.

Accidental short-circuiting can happen when a metallic object touches the metal strips on the battery, for example, if you carry a spare battery in your pocket. Short-circuiting may damage the battery or the connecting object.

Do not dispose of batteries in a fire as they may explode. Dispose of batteries according to local regulations. Recycle when possible. Do not dispose as household waste.

Do not dismantle, cut, open, crush, bend, puncture, or shred cells or batteries. If a battery leaks, do not let battery liquid touch skin or eyes. If this happens, immediately flush the affected areas with water, or seek medical help.

Do not modify, remanufacture, attempt to insert foreign objects into the battery, or immerse or expose it to water or other liquids. Batteries may explode if damaged.

Use the battery and charger for their intended purposes only. Improper use, or use of unapproved batteries or incompatible chargers may present a risk of fire, explosion, or other hazard, and may invalidate any approval or warranty. If you believe the battery or charger is damaged, take it to a service centre for inspection before continuing to use it. Never use a damaged battery or charger. Only use the charger indoors.

### Additional safety information

#### Make an emergency call

- 1 Make sure the device is switched on.
- 2 Check for adequate signal strength. You may also need to do the following:
  - Insert a SIM card.
  - Deactivate call restrictions you have activated for your device, such as call barring, fixed dialling, or closed user group.
  - Make sure the flight profile is not activated.
  - If the device screen and keys are locked, unlock them.
- 3 Press the end key repeatedly, until the home screen is displayed.
- 4 Open the slide.
- 5 Enter the official emergency number for your present location. Emergency call numbers vary by location.
- 6 Press the call key.
- 7 Give the necessary information as accurately as possible. Do not end the call until given permission to do so.

 **Important:** Activate both cellular and internet calls, if your device supports internet calls. The device may attempt to make emergency calls both through cellular networks and through your internet call service provider. Connections in all conditions cannot be guaranteed. Never rely solely on any wireless device for essential communications like medical emergencies.



### Small children

Your device and its accessories are not toys. They may contain small parts. Keep them out of the reach of small children.

### Medical devices

Operation of radio transmitting equipment, including wireless phones, may interfere with the function of inadequately protected medical devices. Consult a physician or the manufacturer of the medical device to determine whether they are adequately shielded from external RF energy. Switch off your device when regulations posted instruct you to do so, for example, in hospitals.

### Implanted medical devices

Manufacturers of medical devices recommend a minimum separation of 15.3 centimetres (6 inches) between a wireless device and an implanted medical device, such as a pacemaker or implanted cardioverter defibrillator, to avoid potential interference with the medical device. Persons who have such devices should:

- Always keep the wireless device more than 15.3 centimetres (6 inches) from the medical device.
- Not carry the wireless device in a breast pocket.
- Hold the wireless device to the ear opposite the medical device.
- Turn the wireless device off if there is any reason to suspect that interference is taking place.
- Follow the manufacturer directions for the implanted medical device.

If you have any questions about using your wireless device with an implanted medical device, consult your health care provider.

### Hearing

 **Warning:** When you use the headset, your ability to hear outside sounds may be affected. Do not use the headset where it can endanger your safety.

Some wireless devices may interfere with some hearing aids.

### Nickel

 **Note:** The surface of this device does not contain nickel in the platings. The surface of this device contains stainless steel.

### Protect your device from harmful content

Your device may be exposed to viruses and other harmful content. Take the following precautions:

- Be cautious when opening messages. They may contain malicious software or otherwise be harmful to your device or computer.
- Be cautious when accepting connectivity requests, browsing the internet, or downloading content. Do not accept Bluetooth connections from sources you do not trust.
- Only install and use services and software from sources that you trust and that offer adequate security and protection.
- Install antivirus and other security software on your device and any connected computer. Only use one antivirus application at a time. Using more may affect performance and operation of the device and/or computer.
- If you access preinstalled bookmarks and links to third party internet sites, take the appropriate precautions. Nokia does not endorse or assume liability for such sites.

### Operating environment

This device meets RF exposure guidelines in the normal use position at the ear or at least 1.5 centimetres (5/8 inch) away from the body. Any carry case, belt clip, or holder for body-worn operation should not contain metal and should position the device the above-stated distance from your body.

## 42 Copyright and other notices

---

To send data files or messages requires a quality connection to the network. Data files or messages may be delayed until such a connection is available. Follow the separation distance instructions until the transmission is completed.

### Vehicles

Radio signals may affect improperly installed or inadequately shielded electronic systems in motor vehicles such as electronic fuel injection, electronic antilock braking, electronic speed control, and air bag systems. For more information, check with the manufacturer of your vehicle or its equipment.

Only qualified personnel should install the device in a vehicle. Faulty installation or service may be dangerous and may invalidate your warranty. Check regularly that all wireless device equipment in your vehicle is mounted and operating properly. Do not store or carry flammable liquids, gases, or explosive materials in the same compartment as the device, its parts, or accessories. Remember that air bags inflate with great force. Do not place your device or accessories in the air bag deployment area.

Switch off your device before boarding an aircraft. The use of wireless devices in an aircraft may be dangerous to the operation of the aircraft and may be illegal.

### Potentially explosive environments

Switch off your device in any area with a potentially explosive atmosphere. Obey all posted instructions. Sparks in such areas could cause an explosion or fire resulting in bodily injury or death. Switch off the device at refuelling points such as near gas pumps at service stations. Observe restrictions in fuel depots, storage, and distribution areas; chemical plants; or where blasting operations are in progress. Areas with a potentially explosive atmosphere are often, but not always, clearly marked. They include areas where you would be advised to turn off your vehicle engine, below deck on boats, chemical transfer or storage facilities and where the air contains chemicals or particles such as grain, dust, or metal powders. You should check with the manufacturers of vehicles using liquefied petroleum gas (such as propane or butane) to determine if this device can be safely used in their vicinity.

### Certification information (SAR)

#### **This mobile device meets guidelines for exposure to radio waves.**

Your mobile device is a radio transmitter and receiver. It is designed not to exceed the limits for exposure to radio waves recommended by international guidelines. These guidelines were developed by the independent scientific organisation ICNIRP and include safety margins designed to assure the protection of all persons, regardless of age and health.

The exposure guidelines for mobile devices employ a unit of measurement known as the Specific Absorption Rate or SAR. The SAR limit stated in the ICNIRP guidelines is 2.0 watts/kilogram (W/kg) averaged over 10 grams of tissue. Tests for SAR are conducted using standard operating positions with the device transmitting at its highest certified power level in all tested frequency bands. The actual SAR level of an operating device can be below the maximum value because the device is designed to use only the power required to reach the network. That amount changes depending on a number of factors such as how close you are to a network base station.

The highest SAR value under the ICNIRP guidelines for use of the device at the ear is 0.61 W/kg.

Use of device accessories may result in different SAR values. SAR values may vary depending on national reporting and testing requirements and the network band. Additional SAR information may be provided under product information at [www.nokia.com](http://www.nokia.com).

## Copyright and other notices

DECLARATION OF CONFORMITY

CE 0434

# CE 0168

Nokia is transitioning between EU Notified Bodies and this product has been approved as complying with EU regulations with both Notified Bodies. Either of the CE marks shown may appear on the product during this transition period.

Hereby, NOKIA CORPORATION declares that this RM-702 product is in compliance with the essential requirements and other relevant provisions of Directive 1999/5/EC. A copy of the Declaration of Conformity can be found at <http://www.nokia.com/global/declaration>.

© 2011 Nokia. All rights reserved.

Nokia, Nokia Connecting People, Ovi, and WE: logo are trademarks or registered trademarks of Nokia Corporation. Nokia tune is a sound mark of Nokia Corporation. Other product and company names mentioned herein may be trademarks or tradenames of their respective owners.

Reproduction, transfer, distribution, or storage of part or all of the contents in this document in any form without the prior written permission of Nokia is prohibited. Nokia operates a policy of continuous development. Nokia reserves the right to make changes and improvements to any of the products described in this document without prior notice.



Includes RSA BSAFE cryptographic or security protocol software from RSA Security.



Java and all Java-based marks are trademarks or registered trademarks of Sun Microsystems, Inc.

Portions of the Nokia Maps software are ©1996-2012 The FreeType Project. All rights reserved.

The Bluetooth word mark and logos are owned by the Bluetooth SIG, Inc. and any use of such marks by Nokia is under license.

This product is licensed under the MPEG-4 Visual Patent Portfolio License (i) for personal and noncommercial use in connection with information which has been encoded in compliance with the MPEG-4 Visual Standard by a consumer engaged in a personal and noncommercial activity and (ii) for use in connection with MPEG-4 video provided by a licensed video provider. No license is granted or shall be implied for any other use. Additional information, including that related to promotional, internal, and commercial uses, may be obtained from MPEG LA, LLC. See <http://www.mpegla.com>.

To the maximum extent permitted by applicable law, under no circumstances shall Nokia or any of its licensors be responsible for any loss of data or income or any special, incidental, consequential or indirect damages howsoever caused.

The contents of this document are provided "as is". Except as required by applicable law, no warranties of any kind, either express or implied, including, but not limited to, the implied warranties of merchantability and fitness for a particular purpose, are made in relation to the accuracy, reliability or contents of this document. Nokia reserves the right to revise this document or withdraw it at any time without prior notice.

The availability of products, features, applications and services may vary by region. For more information, contact your Nokia dealer or your service provider. This device may contain commodities, technology or software subject to export laws and regulations from the US and other countries. Diversion contrary to law is prohibited.

Nokia does not provide a warranty for or take any responsibility for the functionality, content, or end-user support of third-party applications provided with your device. By using an application, you acknowledge that the application is provided as is.

## 44 Copyright and other notices

---

Nokia does not make any representations, provide a warranty, or take any responsibility for the functionality, content, or end-user support of third-party applications provided with your device.  
The availability of Nokia services may vary by region.

Some operations and features are SIM card and/or network dependent, MMS dependent, or dependent on the compatibility of devices and the content formats supported. Some services are subject to a separate charge.

/Issue 1.2 EN

**Index****A**

access codes	11
alarm clock	23
alarms	23
antennas	11

**B**

backing up data	37
battery	6, 39, 40
— charging	9
Bluetooth	24, 25
bookmarks	30
browser	28
business cards	25

**C**

cable connection	25
Calendar	24
calls	
— emergency	40
— log	16
— making	16
camera	
— recording videos	28
— sending pictures and videos	28
— taking pictures	27
charging the battery	39
chat services (IM)	32
clock	23
contacts	
— adding	17
— copying	15
— saving	17
copying content	15, 25

**D**

data connections	
— Bluetooth	24

date and time	23
dictionary	19

**E**

e-mail	31
emergency calls	40
environmental tips	37

**F**

factory settings, restoring	37
file management	37
FM radio	25, 26

**H**

home screen	14, 21
-------------	--------

**I**

IM (instant messaging)	32
IMEI number	11
indicators	14
internet	28

**K**

keyguard	12
keys and parts	5

**L**

lock code	11
locking	
— keys	12
— screen	12
loudspeaker	15

**M**

mail	31
— creating	31
— reading and replying to	31
— sending	31
mailbox	
— voice	21

Maps	32	recording	
— creating routes	34	— videos	28
— current location	33	recycling	37
— searching	33	restoring data	37
— sharing	33	restoring settings	37
meeting entries	24	ringtones	22
memory card	8		
messages		<b>S</b>	
— audio	21	searching	
— copying	15	— radio stations	26
— sending	19	security code	11
MMS (multimedia message service)	19, 20	settings	
multimedia messages	19, 20	— restoring	37
music	27	SIM card	5, 6, 7, 12
		SMS (short message service)	19
<b>N</b>		social networks	30
Nokia support information	35	software updates	35, 36
Nokia's Ovi services	34	speed dialling	17
		strap	10
<b>O</b>		support	35
Ovi by Nokia	34	switching on/off	10
<b>P</b>		<b>T</b>	
personalising your phone	21, 22	taking pictures	
phone		<i>See camera</i>	
— switching on/off	10	text input	17, 18, 19
Phone switch	15	text messages	19
pictures		themes	21
— copying	25	time and date	23
— sending	25, 28	Tips and offers service	35
— taking	27	tones	
PIN codes	11	— personalising	22
powering on/off	10	touch screen	13
predictive text input	17, 19	transferring content	15, 25
profiles		turning on/off	10
— personalising	22		
PUK codes	11	<b>U</b>	
		updates	
<b>R</b>		— phone software	35, 36
radio	25, 26	USB connection	25

**V**

videos	
— copying	25
— playing	27
— recording	28
— sending	25, 28
voice messages	21
volume	15

**W**

web	28
web browser	28
— bookmarks	30
— browsing pages	29
— cookies	30